



CIRCUIT PROTECTION SOLUTIONS



Electronics Circuit Protection Product Selection Guide

A guide to selecting CREATEK circuit protection components for electronic applications.

About CREATEK

CREATEK Microelectronics a leading manufacturer and supplier of electronic components, Its products: circuit protection, magnetic components, power semiconductors, Headquartered in China, R&D center in San Francisco, the sales center in North American, and sales office in Shenzhen, Shanghai, Suzhou, Taiwan, India, Korea.

CREATEK Microelectronics serves a broad range of markets, including automotive, industrial, consumer, communications, non-critical life support medical, audio and various other market segments.

CREATEK Microelectronics team with rich experience on Power semiconductor's researching and producing in domestic and abroad, the founder have be experienced in achieving mass production and sales at first in Chinese IGBT chip. The company owns international advanced technical of design and process in Planar Transformer, IGBT, MOSFETs, FRD, TVS, TSS, SBD etc, and other power semiconductors, also built reliable laboratory which used for power semiconductor's testing and applications .

CREATEK Microelectronics adhering to the mission "Green design, green manufacturing" committed to be a world's leading R&D and manufacture in power electronics. Constantly innovation, further improved the technical level, expand capacity, broaden application range of products, contributed for global energy conservation, reduction of environmental pollution, establishment of green prosperity and a harmonious society.

Markets and Applications

Createk Microelectronics works closely with the world's leading OEM design teams to provide innovative solutions ideal for today's application challenges.

Communications



- Power over Ethernet (PoE)
- I/O interface
- Audio amp
- Data/User interface
- Micro controller protection

Consumer

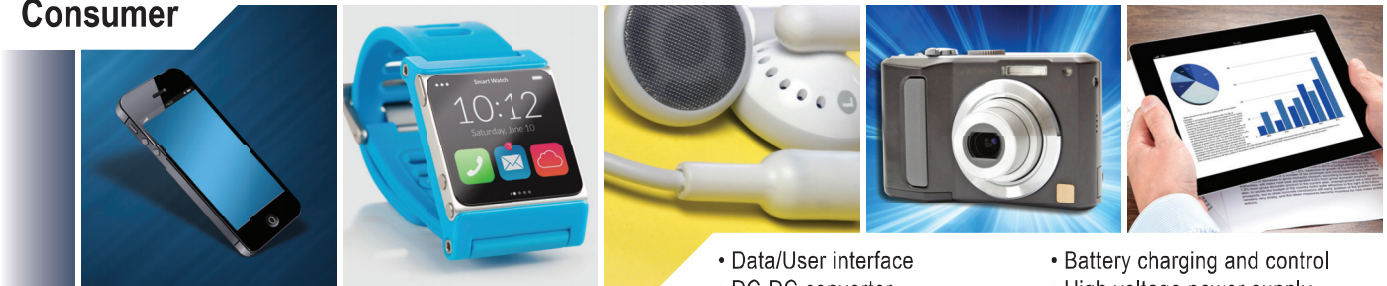

- Data/User interface
- DC-DC converter
- Audio processing
- Battery charging and control
- High voltage power supply
- Power management

Industrial



- Power Factor Correction (PFC)
- Motor control
- Rectification
- Filter/Protection
- I/O interface
- DC-DC converter
- DC-AC inverter
- Battery and charging circuit

Index

ESD Transient Voltage Suppressors

CESD0603NC3V3B-M	07	CESD323UC3V3B	08
CESD0603NC5VB-M	07	CESD323HC4V5U-M	08
CESD0603LC5VB-M	07	CESD323HC4V5B	08
CESD0603UC5VB-M	07	CESD323NC5VU-M	08
CESD0603UC5VBS	07	CESD323NC5VU	08
CESD0603NC12VB	07	CESD323NC5VB	08
CESD0603NC20VB	07	CESD323LC5VB-M	08
CESD0603NC24VB	07	CESD323LC5VBL	08
CESD0603LC24VB	07	CESD323LC5VB	08
CESD882NC5VB	07	CESD323UC5VB	08
CESD882LC5VB-M	07	CESD323HC5VU	08
CESD882UC5VB	07	CESD323HC7VU-M	08
CESD1006NC3V3B	07	CESD323HC7VUL	08
CESD1006LC3V3B	07	CESD323HC7VU	08
CESD1006HC3V3B	07	CESD323NC8VU-M	08
CESD1006NC4V5B	07	CESD323NC8VU	08
CESD1006HC4V5B	07	CESD323NC8VB	08
CESD1006NC5VB	07	CESD323LC8VB	08
CESD1006LC5VU	07	CESD323NC12VU-M	08
CESD1006LC5VB	07	CESD323NC12VU	08
CESD1006UC5VU	07	CESD323HC12VU-M	09
CESD1006UC5VB	07	CESD323HC12VUL	09
CESD1006UC5VBS	07	CESD323HC12VU	09
CESD1006HC5VB	07	CESD323NC12VB	09
CESD1006NC8VB	07	CESD323LC12VB	09
CESD1006NC12VB	07	CESD323NC15VU-M	09
CESD1006HC12VB	07	CESD323NC15VU	09
CESD1006NC15VB	07	CESD323HC15VU	09
CESD1006NC24VU	07	CESD323NC15VB	09
CESD1006NC24VB	07	CESD323LC15VB	09
CESD1006NC36VU	07	CESD323NC18VB	09
CESD1006NC36VB	07	CESD323NC24VU-M	09
CESD0402NC5VB	07	CESD323NC24VU	09
CESD923NC5VB	07	CESD323NC24VB	09
CESD523NC3V3U	07	CESD323LC24VB	09
CESD523NC3V3B	07	CESD323NC36VU	09
CESD523NC5VU	08	CESD323NC36VB	09
CESD523NC5VB-M	08	CEST883NC5VB	09
CESD523NC5VB	08	CEST883UC5VU	09
CESD523LC5VB	08	CEST523NC5VB	09
CESD523UC5VB-M	08	CEST12M	09
CESD523UC5VB	08	CEST23LC2V8U	09
CESD523NC7VU	08	CEST23NC3V3U	09
CESD523NC12VU	08	CEST23NC3V3B	09
CESD523NC15VU	08	CEST23LC3V3B	09
CESD523NC24VU	08	CEST23NC5VU	09
CESD523NC36VU	08	CEST23NC5VB	09
CESD323NC3VU-M	08	CEST23LC5VU	09
CESD323NC3VU	08	CEST23LC5VB	09
CESD323NC3V3B	08	CEST23UC5VU	09
CESD323LC3V3B	08	CEST23NC8VU	09

ESD Transient Voltage Suppressors

CEST23LC8VU	09
CEST23NC8VB	09
CEST23NC12VU	09
CEST23LC12VU	09
CEST23NC12VB	09
CEST23NC15VU	09
CEST23LC15VU	09
CEST23NC15VB	10
CEST23NC24VU	10
CEST23NC24VB	10
CEST23NC36VU	10
CEST23NC36VB	10
CEST143LC5VU	10
CEST143UC5VU	10
CEST353NC5VU	10
CEST363NC5VU	10
CEST363LC5VU	10
CEST553NC5VU	10
CEST563NC5VU	10
CEST563LC5VU	10
CEST235NC5VB	10
CEST236HLC5VU	10
CEST236LC5VU-M	10
CEST236LC5VU	10
CEST236SLC5VU	10
CEST236UC5VU	10
CESD1308UC5VU	10
CESD1610LC5VU	10
CESD2010LC2V8U	10
CESD2010LC3V3U	10
CESD2010UC5VU	10
CESD2010UC5VB	10
CESD2020LC5VU	10
CESD2020HC4V5U	10
CESD2020HC4V5B	10
CESD2020HC7VU	10
CESD2020HC12VU	10
CESD2020HC15VU	10
CESD2510LC5VU-S	10
CESD2510LC5VU-M	10
CESD2510LC5VU	10
CESD2510UC3V3U	10
CESD2510UC5VU	10
CESD2510UC5VUS	11
CESD2626LC2V5U	11
CESD2626LC3V3U	11
CESD3020LC2V5U	11
CESD3310UC5VU	11
CESD3810UC5VU	11
CESD4120UC5VU	11
CESP8LC2V8U	11

CESP8LC3V3U	11
CESDP0201UC5VB	11
CESDP0201UC12VB	11
CESDP0402UC5VB	11
CESDP0402UC12VB	11
CESDP0402UC15VB	11
CESDP0402UC18VB	11
CESDP0402UC24VB	11
CESDP0603UC5VB	11
CESDP0603UC12VB	11
CESDP0603UC15VB	11
CESDP0603UC18VB	11
CESDP0603UC24VB	11
CESDP0603UC30VB	11
CESDP2510UC5VB	11
CESDP2510UC12VB	11
CPESD0402UC5VB	11
CPESD0402UC12VB	11
CPESD0603UC5VB	11
CPESD0603UC30VB	11

Power Transient Voltage Suppressors

SODJ Series	12~13
SOD4J Series	13~14
SMAJ Series	14~15
P4SMA Series	16~17
SMA6J Series	17~18
SMBJ Series	18~19
P6SMBJ Series	19~20
1.0SMBJ Series	20~21
1.5SMBJ Series	22~23
SMCJ Series	23~24
SMDJ Series	24~26
5.0SMDJ Series	26~27
SM8S Series	27~28

Thyristor Surge Suppressors

CP Series	28
-----------	----

Programmable Thyristor Surge Suppressors

CG170D	29
CG170Q	29
CG110S	29

Ceramic PTC Thermistors

CPS100M	29
CPS250M	29
CPS500M	29
CPT250M	29
CPT500M	29
CPT500KH	29

Index

Package Mechanical Specifications

DFN0603	30
SOD-882	30
DFN1006	30
SOD-923	30
SOD-523	31
SOD-323	31
SOT-883	31
SOT-523	31
SOT-23	32
SOT-143	32
SOT-353	32
SOT-363	32
SOT-553	33
SOT-563	33
SOT-23-6L	33
DFN1308	33
DFN1610	34
DFN1616	34
DFN2010	34
DFN2020-6L	34
DFN2020-3L	35
DFN2510	35
DFN2626	35
DFN3020	35
DFN3310	36
DFN3810	36
DFN4120	36
SOD-123FL	36
SMA	37
SMB	37
SMC	37
DO-218AB	37
SOP-8	38
8-SOIC	38
PTH-1	38
SMT-1	38

ESD Transient Voltage Suppressors

Part Number	Package	Dir.	Config.	VRWM (V)	IR max(uA)	VBR min(V)	C typ.(pF)	I _{PP} (A)	P _{PP} (W)
CESD0603NC3V3B-M	DFN0603	Bi-Dir	Single	3.3	0.2	3.4	12	6.0	48
CESD0603NC5VB-M	DFN0603	Bi-Dir	Single	5.0	0.5	5.5	6	6.0	65
CESD0603LC5VB-M	DFN0603	Bi-Dir	Single	5.0	0.5	5.5	2.7	3.5	40
CESD0603UC5VB-M	DFN0603	Bi-Dir	Single	5.0	0.1	5.5	0.2	5.0	100
CESD0603UC5VBS	DFN0603	Bi-Dir	Single	5.0	0.5	6.0	0.2	4.0	24
CESD0603NC12VB	DFN0603	Bi-Dir	Single	12.0	0.5	13.3	10	5.0	120
CESD0603NC20VB	DFN0603	Bi-Dir	Single	20.0	0.5	22.5	10	2.0	68
CESD0603NC24VB	DFN0603	Bi-Dir	Single	24.0	0.5	27.0	10	2.0	100
CESD0603LC24VB	DFN0603	Bi-Dir	Single	24.0	1.0	27.0	2.7	1.0	45
CESD882NC5VB	SOD-882	Bi-Dir	Single	5.0	1.0	5.6	15	9.4	150
CESD882LC5VB-M	SOD-882	Bi-Dir	Single	5.0	0.5	6.5	2.7	3.5	40
CESD882UC5VB	SOD-882	Bi-Dir	Single	5.0	0.1	6.5	0.2	5.0	100
CESD1006NC3V3B	DFN1006	Bi-Dir	Single	3.3	0.2	3.8	12	10	80
CESD1006LC3V3B	DFN1006	Bi-Dir	Single	3.3	0.5	3.5	6.8	6.0	80
CESD1006HC3V3B	DFN1006	Bi-Dir	Single	3.3	0.1	4.7	70	45	500
CESD1006NC4V5B	DFN1006	Bi-Dir	Single	4.5	0.2	5.1	18	11	80
CESD1006HC4V5B	DFN1006	Bi-Dir	Single	4.5	0.2	5.1	70	45	500
CESD1006NC5VB	DFN1006	Bi-Dir	Single	5.0	1.0	6.0	6	6.0	60
CESD1006LC5VU	DFN1006	Uni-Dir	Single	5.0	0.5	6.0	1.2	7.0	70
CESD1006LC5VB	DFN1006	Bi-Dir	Single	5.0	0.5	5.5	3	3.5	45
CESD1006UC5VU	DFN1006	Uni-Dir	Single	5.0	0.5	6.0	0.7	3.0	40
CESD1006UC5VB	DFN1006	Bi-Dir	Single	5.0	0.5	6.0	0.35	3.0	40
CESD1006UC5VBS	DFN1006	Bi-Dir	Single	5.0	0.5	6.0	0.2	4.0	24
CESD1006HC5VB	DFN1006	Bi-Dir	Single	5.0	0.5	6.0	30	18	200
CESD1006NC8VB	DFN1006	Bi-Dir	Single	8.0	0.5	9.0	45	19	350
CESD1006NC12VB	DFN1006	Bi-Dir	Single	12.0	0.5	13.3	10	5.0	120
CESD1006HC12VB	DFN1006	Bi-Dir	Single	12.0	0.5	13.3	31	11	280
CESD1006NC15VB	DFN1006	Bi-Dir	Single	15.0	0.5	16.7	25	10	300
CESD1006NC24VU	DFN1006	Uni-Dir	Single	24.0	0.5	26.7	20	6.0	240
CESD1006NC24VB	DFN1006	Bi-Dir	Single	24.0	0.5	26.7	35	6.0	260
CESD1006NC36VU	DFN1006	Uni-Dir	Single	36.0	0.5	40.0	25	4.0	280
CESD1006NC36VB	DFN1006	Bi-Dir	Single	36.0	0.5	40.0	25	4.0	280
CESD0402NC5VB	0402	Bi-Dir	Single	5.0	1.0	5.6	15	5.0	60
CESD923NC5VB	SOD-923	Bi-Dir	Single	5.0	1.0	6.0	15	8.0	100
CESD523NC3V3U	SOD-523	Uni-Dir	Single	3.3	1.0	5.0	105	11.2	158
CESD523NC3V3B	SOD-523	Bi-Dir	Single	3.3	0.2	3.5	12	7.0	100

ESD Transient Voltage Suppressors

Part Number	Package	Dir.	Config.	V _{RWM} (V)	I _R max(uA)	V _{BR} min(V)	C typ.(pF)	I _{PP} (A)	P _{PP} (W)
CESD523NC5VU	SOD-523	Uni-Dir	Single	5.0	0.5	6.0	80	15	270
CESD523NC5VB-M	SOD-523	Bi-Dir	Single	5.0	1.0	5.5	5	5.0	75
CESD523NC5VB	SOD-523	Bi-Dir	Single	5.0	1.0	5.6	13	10	100
CESD523LC5VB	SOD-523	Bi-Dir	Single	5.0	0.1	5.5	2.7	3.5	40
CESD523UC5VB-M	SOD-523	Bi-Dir	Single	5.0	0.5	6.0	0.2	3.0	60
CESD523UC5VB	SOD-523	Bi-Dir	Single	5.0	0.5	6.0	0.7	7.0	100
CESD523NC7VU	SOD-523	Uni-Dir	Single	7.0	1.0	8.0	100	15	400
CESD523NC12VU	SOD-523	Uni-Dir	Single	12.0	1.0	13.3	42	15	250
CESD523NC12VB	SOD-523	Bi-Dir	Single	12.0	1.0	13.3	10	5.0	120
CESD523NC15VU	SOD-523	Uni-Dir	Single	15.0	1.0	16.7	48	9.5	320
CESD523NC24VU	SOD-523	Uni-Dir	Single	24.0	1.0	26.7	30	5.0	220
CESD523NC36VU	SOD-523	Uni-Dir	Single	36.0	0.5	40.0	25	4.0	280
CESD323NC3VU-M	SOD-323	Uni-Dir	Single	3.0	1.0	4.0	110	15	200
CESD323NC3VU	SOD-323	Uni-Dir	Single	3.0	1.0	4.0	100	20	350
CESD323NC3V3B	SOD-323	Bi-Dir	Single	3.3	0.2	4.0	37	30	450
CESD323LC3V3B	SOD-323	Bi-Dir	Single	3.3	1.0	4.0	1	20	350
CESD323UC3V3B	SOD-323	Bi-Dir	Single	3.3	0.5	4.0	0.6	20	300
CESD323HC4V5U-M	SOD-323	Uni-Dir	Single	4.5	1.0	5.0	560	70	1800
CESD323HC4V5B	SOD-323	Bi-Dir	Single	4.5	0.5	5.3	300	140	2500
CESD323NC5VU-M	SOD-323	Uni-Dir	Single	5.0	1.0	6.0	90	12	200
CESD323NC5VU	SOD-323	Uni-Dir	Single	5.0	1.0	6.0	120	20	350
CESD323NC5VB	SOD-323	Bi-Dir	Single	5.0	1.0	6.0	20	20	350
CESD323LC5VB-M	SOD-323	Bi-Dir	Single	5.0	0.5	5.5	2.7	3.5	40
CESD323LC5VB	SOD-323	Bi-Dir	Single	5.0	1.0	6.0	1	20	350
CESD323LC5VB-S	SOD-323	Bi-Dir	Single	5.0	0.5	6.0	1.5	15	200
CESD323UC5VB	SOD-323	Bi-Dir	Single	5.0	0.5	6.0	0.7	7.0	100
CESD323HC5VU	SOD-323	Uni-Dir	Single	5.0	1.0	6.0	950	140	2500
CESD323HC7VU-M	SOD-323	Uni-Dir	Single	7.0	1.0	7.5	390	65	1800
CESD323HC7VUL	SOD-323	Uni-Dir	Single	7.0	1.0	7.5	650	110	2200
CESD323HC7VU	SOD-323	Uni-Dir	Single	7.0	0.5	8.0	950	135	2700
CESD323NC8VU-M	SOD-323	Uni-Dir	Single	8.0	1.0	9.0	90	10	200
CESD323NC8VU	SOD-323	Uni-Dir	Single	8.0	1.0	9.0	90	15	350
CESD323NC8VB	SOD-323	Bi-Dir	Single	8.0	1.0	9.0	45	15	350
CESD323LC8VB	SOD-323	Bi-Dir	Single	8.0	1.0	9.0	1	15	350
CESD323NC12VU-M	SOD-323	Uni-Dir	Single	12.0	1.0	13.3	60	8	240
CESD323NC12VU	SOD-323	Uni-Dir	Single	12.0	1.0	13.3	60	10	240

ESD Transient Voltage Suppressors

Part Number	Package	Dir.	Config.	V _{RWM} (V)	I _R max(uA)	V _{BR} min(V)	C typ.(pF)	I _{PP} (A)	P _{PP} (W)
CESD323HC12VU-M	SOD-323	Uni-Dir	Single	12.0	1.0	13.3	250	50	1500
CES323HC12VUL	SOD-323	Uni-Dir	Single	12.0	1.0	13.5	350	55	1500
CESD323HC12VU	SOD-323	Uni-Dir	Single	12.0	1.0	13.3	350	80	2200
CESD323NC12VB	SOD-323	Bi-Dir	Single	12.0	1.0	13.3	30	8	240
CESD323LC12VB	SOD-323	Bi-Dir	Single	12.0	1.0	13.3	1	8	240
CESD323NC15VU-M	SOD-323	Uni-Dir	Single	15.0	0.5	16.7	45	6	200
CESD323NC15VU	SOD-323	Uni-Dir	Single	15.0	0.5	16.7	45	10	350
CESD323HC15VU	SOD-323	Uni-Dir	Single	15.0	1.0	16.0	330	70	2000
CESD323NC15VB	SOD-323	Bi-Dir	Single	15.0	1.0	16.7	10	15	450
CESD323LC15VB	SOD-323	Bi-Dir	Single	15.0	1.0	16.7	1	6.0	240
CESD323NC18VB	SOD-323	Bi-Dir	Single	18.0	0.5	19.8	12	5.5	220
CESD323NC24VU-M	SOD-323	Uni-Dir	Single	24.0	1.0	26.7	30	4.5	200
CESD323NC24VU	SOD-323	Uni-Dir	Single	24.0	1.0	26.7	30	6.0	240
CESD323NC24VB	SOD-323	Bi-Dir	Single	24.0	1.0	26.7	15	15	450
CESD323LC24VB	SOD-323	Bi-Dir	Single	24.0	1.0	25.6	1	6.0	240
CESD323NC36VU	SOD-323	Uni-Dir	Single	36.0	1.0	40.0	25	6.0	540
CESD323NC36VB	SOD-323	Bi-Dir	Single	36.0	1.0	40.0	15	5.0	540
CEST883NC5VB	SOT-883	Bi-Dir	Array	5.0	0.5	6.0	6	5.0	60
CEST883UC5VU	SOT-883	Uni-Dir	Array	5.0	0.5	6.0	0.3	4.0	50
CEST523NC5VB	SOT-523	Bi-Dir	Array	5.0	1.0	5.8	10	10	110
CEST712M	SOT-23	Bi-Dir	Array	12/7	1.0	13.3/7.5	60	12	400
CEST23LC2V8U	SOT-23	Uni-Dir	Array	2.8	0.5	3.5	0.5	22	350
CEST23NC3V3U	SOT-23	Uni-Dir	Array	3.3	0.5	4.0	100	24	380
CEST23NC3V3B	SOT-23	Bi-Dir	Array	3.3	0.5	4.0	100	24	450
CEST23LC3V3B	SOT-23	Bi-Dir	Array	3.3	1.0	4.5	2.7	3.5	40
CEST23NC5VU	SOT-23	Uni-Dir	Array	5.0	1.0	6.0	60	16.7	300
CEST23NC5VB	SOT-23	Bi-Dir	Array	5.0	1.0	6.0	75	18	450
CEST23LC5VU	SOT-23	Uni-Dir	Array	5.0	0.5	6.0	0.5	22	350
CEST23LC5VB	SOT-23	Bi-Dir	Array	5.0	1.0	5.5	2.7	3.5	40
CEST23UC5VU	SOT-23	Uni-Dir	Array	5.0	1.0	6.0	0.25	5.0	100
CEST23NC8VU	SOT-23	Uni-Dir	Array	8.0	0.5	9.0	35	15	350
CEST23LC8VU	SOT-23	Uni-Dir	Array	8.0	0.5	9.0	0.5	15	350
CEST23NC8VB	SOT-23	Bi-Dir	Array	8.0	0.5	9.0	35	20	350
CEST23NC12VU	SOT-23	Uni-Dir	Array	12.0	1.0	13.3	60	10	300
CEST23LC12VU	SOT-23	Uni-Dir	Array	12.0	0.5	13.3	0.5	10	300
CEST23NC12VB	SOT-23	Bi-Dir	Array	12.0	1.0	13.3	30	10	300
CEST23NC15VU	SOT-23	Uni-Dir	Array	15.0	0.5	16.7	50	10	300
CEST23LC15VU	SOT-23	Uni-Dir	Array	15.0	1.0	16.7	0.5	8.0	300

ESD Transient Voltage Suppressors

Part Number	Package	Dir.	Config.	V _{RWM} (V)	I _R max(uA)	V _{BR} min(V)	C typ.(pF)	I _{PP} (A)	P _{PP} (W)
CEST23NC15VB	SOT-23	Bi-Dir	Array	15.0	1.0	16.7	25	10	300
CEST23NC24VU	SOT-23	Uni-Dir	Array	24.0	0.5	26.7	15	6.0	300
CEST23LC24VU	SOT-23	Uni-Dir	Array	24.0	1.0	26.7	0.5	6.0	350
CEST23NC24VB	SOT-23	Bi-Dir	Array	24.0	1.0	26.7	15	5.0	250
CEST23NC36VU	SOT-23	Uni-Dir	Array	36.0	1.0	40.0	40	4.0	300
CEST23NC36VB	SOT-23	Bi-Dir	Array	36.0	1.0	40.0	20	4.0	250
CEST143LC5VU	SOT-143	Uni-Dir	Array	5.0	5.0	6.0	3	28	500
CEST143UC5VU	SOT-143	Uni-Dir	Array	5.0	0.5	6.0	0.3	6.0	100
CEST353NC5VU	SOT-353	Uni-Dir	Array	5.0	1.0	6.0	22	6.0	100
CEST363NC5VU	SOT-363	Uni-Dir	Array	5.0	5.0	6.0	30	6.0	60
CEST363LC5VU	SOT-363	Uni-Dir	Array	5.0	1.0	6.0	0.5	6.0	120
CEST553NC5VU	SOT-553	Uni-Dir	Array	5.0	1.0	6.0	6.5	2.0	30
CEST563NC5VU	SOT-563	Uni-Dir	Array	5.0	1.0	6.0	30	10	100
CEST563LC5VU	SOT-563	Uni-Dir	Array	5.0	1.0	5.8	0.2	5.0	125
CEST235NC5VB	SOT-23-5L	Bi-Dir	Array	5.0	1.0	6.0	6	6.0	60
CEST236HLC5VU	SOT-23-6L	Uni-Dir	Array	5.0	0.5	6.0	1.2	8.0	140
CEST236LC5VU-M	SOT-23-6L	Uni-Dir	Array	5.0	0.5	5.8	0.2	5.0	100
CEST236LC5VU	SOT-23-6L	Uni-Dir	Array	5.0	0.5	5.5	0.2	3.0	60
CEST236SLC5VU	SOT-23-6L	Uni-Dir	Array	5.0	1.0	6.0	1.5	12	360
CEST236UC5VU	SOT-23-6L	Uni-Dir	Array	5.0	0.5	6.0	0.15	3.0	30
CESD1308UC5VU	DFN1308	Uni-Dir	Array	5.0	0.5	6.0	0.2	3.0	30
CESD1610LC5VU	DFN1610	Uni-Dir	Array	5.0	1.0	5.6	0.4	5.0	100
CESD1616LC5VU	DFN1616-6L	Uni-Dir	Array	5.0	0.2	6.0	0.4	4.5	68
CESD2010LC2V8U	DFN2010	Uni-Dir	Array	2.8	0.5	3.5	1	5.0	100
CESD2010LC3V3U	DFN2010	Uni-Dir	Array	3.3	0.5	3.6	2	6.0	80
CESD2010UC5VU	DFN2010	Uni-Dir	Array	5.0	0.5	6.0	0.2	3.0	30
CESD2010UC5VB	DFN2010	Bi-Dir	Array	5.0	0.1	6.0	0.2	3.0	75
CESD2020LC5VU	DFN2020-6L	Uni-Dir	Array	5/26	0.1	6/28.9	0.4	5/10	100/400
CESD2020HC4V5U	DFN2020-3L	Uni-Dir	Array	4.5	1.0	5.0	725	200	5000
CESD2020HC4V5B	DFN2020-3L	Uni-Dir	Single	4.5	0.3	5.0	700	290	6000
CESD2020HC7VU	DFN2020-3L	Uni-Dir	Single	7.0	1.0	8.0	1700	240	5000
CESD2020HC12VU	DFN2020-3L	Uni-Dir	Single	12.0	1.0	13.5	950	180	5000
CESD2020HC15VU	DFN2020-3L	Uni-Dir	Single	15.0	1.0	16.6	950	150	5000
CESD2510LC5VU-S	DFN2510	Uni-Dir	Array	5.0	1.0	6.0	0.3	6.0	100
CESD2510LC5VU-M	DFN2510	Uni-Dir	Array	5.0	1.0	6.0	0.3	7.0	120
CESD2510LC5VU	DFN2510	Uni-Dir	Array	5.0	1.0	6.0	0.3	5.0	90

ESD Transient Voltage Suppressors

Part Number	Package	Dir.	Config.	V _{RWM} (V)	I _R max(μA)	V _{BR} min(V)	C typ.(pF)	I _{PP} (A)	P _{PP} (W)
CESD2510UC3V3U	DFN2510	Uni-Dir	Array	3.3	0.5	3.5	0.2	3.0	30
CESD2510UC5VU	DFN2510	Uni-Dir	Array	5.0	1.0	6.0	0.2	3.0	30
CESD2510UC5VUS	DFN2510	Uni-Dir	Array	5.0	0.5	6.0	0.2	4.0	24
CESD2626LC2V5U	DFN2626	Uni-Dir	Array	2.5	1.0	3.0	2	25	450
CESD2626LC3V3U	DFN2626	Uni-Dir	Array	3.3	1.0	3.5	2	25	450
CESD3020LC2V5U	DFN3020	Uni-Dir	Array	2.5	0.5	3.0	1.7	40	1000
CESD3020LC3V3U	DFN3020	Uni-Dir	Array	3.3	0.5	3.8	1.7	40	1000
CESD3310UC5VU	DFN3310	Uni-Dir	Array	5.0	0.5	6.0	0.2	3.0	30
CESD3810UC5VU	DFN3810	Uni-Dir	Array	5.0	0.5	6.0	0.2	3.0	30
CESD4120UC5VU	DFN4120	Uni-Dir	Array	5.0	1.0	6.0	0.1	1.0	12
CESP8LC2V8U	SOP-8	Bi-Dir	Array	2.8	1.0	3.0	6	30	600
CESP8LC3V3U	SOP-8	Bi-Dir	Array	3.3	0.5	3.7	5	100	1800

Part Number	Package	Dir.	Config.	V _R (V)	I _L (μA)	C typ.(pF)			
CESDP0201UC5VB	0201	Bi-Dir	Single	5.0	0.1	0.05			
CESDP0201UC12VB	0201	Bi-Dir	Single	12.0	0.1	0.05			
CESDP0402UC5VB	0402	Bi-Dir	Single	5.0	0.1	0.05			
CESDP0402UC12VB	0402	Bi-Dir	Single	12.0	0.1	0.05			
CESDP0402UC15VB	0402	Bi-Dir	Single	15.0	0.1	0.05			
CESDP0402UC18VB	0402	Bi-Dir	Single	18.0	0.1	0.05			
CESDP0402UC24VB	0402	Bi-Dir	Single	24.0	0.1	0.05			
CESDP0603UC5VB	0603	Bi-Dir	Single	5.0	0.1	0.05			
CESDP0603UC12VB	0603	Bi-Dir	Single	12.0	0.1	0.05			
CESDP0603UC15VB	0603	Bi-Dir	Single	15.0	0.1	0.05			
CESDP0603UC18VB	0603	Bi-Dir	Single	18.0	0.1	0.05			
CESDP0603UC24VB	0603	Bi-Dir	Single	24.0	0.1	0.05			
CESDP0603UC30VB	0603	Bi-Dir	Single	30.0	0.1	0.05			
CESDP2510UC5VB	2510	Bi-Dir	Array	5.0	0.1	0.05			
CESDP2510UC12VB	2510	Bi-Dir	Array	12.0	0.1	0.05			
CPESD0402UC5VB	0402	Bi-Dir	Single	5.0	0.1	0.05			
CPESD0402UC12VB	0402	Bi-Dir	Single	12.0	0.1	0.05			
CPESD0603UC5VB	0603	Bi-Dir	Single	5.0	0.1	0.05			
CPESD0603UC30VB	0603	Bi-Dir	Single	30.0	0.1	0.05			

Power Transient Voltage Suppressors

Part Number		Package	V _{RWM} (V)	I _R max(μA)	V _{BR} min(V)	V _{BR} max(V)	I _{PP} (A)	V _C max(V)	P _{PP} (W)
SODJ5.0A	SODJ5.0CA	SOD-123FL	5.0	400	6.4	7.07	21.74	9.2	200
SODJ6.0A	SODJ6.0CA	SOD-123FL	6.0	400	6.67	7.37	19.42	10.3	200
SODJ6.5A	SODJ6.5CA	SOD-123FL	6.5	250	7.22	7.98	17.86	11.2	200
SODJ7.0A	SODJ7.0CA	SOD-123FL	7.0	200	7.78	8.60	16.67	12.0	200
SODJ7.5A	SODJ7.5CA	SOD-123FL	7.5	100	8.33	9.21	15.51	12.9	200
SODJ8.0A	SODJ8.0CA	SOD-123FL	8.0	50	8.89	9.83	14.71	13.6	200
SODJ8.5A	SODJ8.5CA	SOD-123FL	8.5	10	9.44	10.40	13.89	14.4	200
SODJ9.0A	SODJ9.0CA	SOD-123FL	9.0	5	10.00	11.10	12.99	15.4	200
SODJ10A	SODJ10CA	SOD-123FL	10.0	5	11.10	12.30	11.77	17.0	200
SODJ11A	SODJ11CA	SOD-123FL	11.0	1	12.20	13.50	10.99	18.2	200
SODJ12A	SODJ12CA	SOD-123FL	12.0	1	13.30	14.70	10.05	19.9	200
SODJ13A	SODJ13CA	SOD-123FL	13.0	1	14.40	15.90	9.30	21.5	200
SODJ14A	SODJ14CA	SOD-123FL	14.0	1	15.60	17.20	8.62	23.2	200
SODJ15A	SODJ15CA	SOD-123FL	15.0	1	16.70	18.50	8.20	24.4	200
SODJ16A	SODJ16CA	SOD-123FL	16.0	1	17.80	19.70	7.69	26.0	200
SODJ17A	SODJ17CA	SOD-123FL	17.0	1	18.90	20.90	7.25	27.6	200
SODJ18A	SODJ18CA	SOD-123FL	18.0	1	20.00	22.10	6.85	29.2	200
SODJ19A	SODJ19CA	SOD-123FL	19.0	1	21.10	23.30	6.50	30.8	200
SODJ20A	SODJ20CA	SOD-123FL	20.0	1	22.20	24.50	6.18	32.4	200
SODJ22A	SODJ22CA	SOD-123FL	22.0	1	24.40	26.90	5.64	35.5	200
SODJ24A	SODJ24CA	SOD-123FL	24.0	1	26.70	29.50	5.14	38.9	200
SODJ26A	SODJ26CA	SOD-123FL	26.0	1	28.90	31.90	4.75	42.1	200
SODJ28A	SODJ28CA	SOD-123FL	28.0	1	31.10	34.40	4.41	45.4	200
SODJ30A	SODJ30CA	SOD-123FL	30.0	1	33.30	36.80	4.13	48.4	200
SODJ33A	SODJ33CA	SOD-123FL	33.0	1	36.70	40.60	3.75	53.3	200
SODJ36A	SODJ36CA	SOD-123FL	36.0	1	40.00	44.20	3.44	58.1	200
SODJ40A	SODJ40CA	SOD-123FL	40.0	1	44.40	49.10	3.10	64.5	200
SODJ43A	SODJ43CA	SOD-123FL	43.0	1	47.80	52.80	2.88	69.4	200
SODJ45A	SODJ45CA	SOD-123FL	45.0	1	50.00	55.30	2.75	72.7	200
SODJ48A	SODJ48CA	SOD-123FL	48.0	1	53.30	58.90	2.59	77.4	200
SODJ51A	SODJ51CA	SOD-123FL	51.0	1	56.70	62.70	2.43	82.4	200
SODJ54A	SODJ54CA	SOD-123FL	54.0	1	60.00	66.30	2.30	87.1	200
SODJ58A	SODJ58CA	SOD-123FL	58.0	1	64.40	71.20	2.14	93.6	200
SODJ60A	SODJ60CA	SOD-123FL	60.0	1	66.70	73.70	2.07	96.8	200
SODJ64A	SODJ64CA	SOD-123FL	64.0	1	71.10	78.60	1.94	103.0	200
SODJ70A	SODJ70CA	SOD-123FL	70.0	1	77.80	86.00	1.77	113.0	200
SODJ75A	SODJ75CA	SOD-123FL	75.0	1	83.30	92.10	1.66	121.0	200
SODJ78A	SODJ78CA	SOD-123FL	78.0	1	86.70	95.80	1.59	126.0	200

Power Transient Voltage Suppressors

Part Number		Package	V _{RWM} (V)	I _R max(μA)	V _{BR} min(V)	V _{BR} max(V)	I _{PP} (A)	V _C max(V)	P _{PP} (W)
SODJ85A	SODJ85CA	SOD-123FL	85.0	1	94.40	104.00	1.46	137.0	200
SODJ90A	SODJ90CA	SOD-123FL	90.0	1	100.00	111.00	1.37	146.0	200
SODJ100A	SODJ100CA	SOD-123FL	100.0	1	111.00	123.00	1.24	162.0	200
SODJ110A	SODJ110CA	SOD-123FL	110.0	1	122.00	135.00	1.13	177.0	200
SODJ120A	SODJ120CA	SOD-123FL	120.0	1	133.00	147.00	1.04	193.0	200
SODJ130A	SODJ130CA	SOD-123FL	130.0	1	144.00	159.00	0.96	209.0	200
SODJ140A	SODJ140CA	SOD-123FL	140.0	1	155.00	171.00	0.88	226.8	200
SODJ150A	SODJ150CA	SOD-123FL	150.0	1	167.00	185.00	0.83	243.0	200
SODJ160A	SODJ160CA	SOD-123FL	160.0	1	178.00	197.00	0.77	259.0	200
SODJ170A	SODJ170CA	SOD-123FL	170.0	1	189.00	209.00	0.73	275.0	200
SOD4J5.0A	SOD4J5.0CA	SOD-123FL	5.0	800	6.4	7.07	43.48	9.2	400
SOD4J6.0A	SOD4J6.0CA	SOD-123FL	6.0	800	6.67	7.37	38.83	10.3	400
SOD4J6.5A	SOD4J6.5CA	SOD-123FL	6.5	500	7.22	7.98	35.71	11.2	400
SOD4J7.0A	SOD4J7.0CA	SOD-123FL	7.0	200	7.78	8.60	33.33	12.0	400
SOD4J7.5A	SOD4J7.5CA	SOD-123FL	7.5	100	8.33	9.21	31.01	12.9	400
SOD4J8.0A	SOD4J8.0CA	SOD-123FL	8.0	50	8.89	9.83	29.41	13.6	400
SOD4J8.5A	SOD4J8.5CA	SOD-123FL	8.5	10	9.44	10.40	27.78	14.4	400
SOD4J9.0A	SOD4J9.0CA	SOD-123FL	9.0	5	10.00	11.10	25.97	15.4	400
SOD4J10A	SOD4J10CA	SOD-123FL	10.0	5	11.10	12.30	23.53	17.0	400
SOD4J11A	SOD4J11CA	SOD-123FL	11.0	1	12.20	13.50	21.98	18.2	400
SOD4J12A	SOD4J12CA	SOD-123FL	12.0	1	13.30	14.70	20.10	19.9	400
SOD4J13A	SOD4J13CA	SOD-123FL	13.0	1	14.40	15.90	18.60	21.5	400
SOD4J14A	SOD4J14CA	SOD-123FL	14.0	1	15.60	17.20	17.24	23.2	400
SOD4J15A	SOD4J15CA	SOD-123FL	15.0	1	16.70	18.50	16.39	24.4	400
SOD4J16A	SOD4J16CA	SOD-123FL	16.0	1	17.80	19.70	15.38	26.0	400
SOD4J17A	SOD4J17CA	SOD-123FL	17.0	1	18.90	20.90	14.49	27.6	400
SOD4J18A	SOD4J18CA	SOD-123FL	18.0	1	20.00	22.10	13.70	29.2	400
SOD4J19A	SOD4J19CA	SOD-123FL	19.0	1	21.10	23.30	13.00	30.8	400
SOD4J20A	SOD4J20CA	SOD-123FL	20.0	1	22.20	24.50	12.35	32.4	400
SOD4J22A	SOD4J22CA	SOD-123FL	22.0	1	24.40	26.90	11.27	35.5	400
SOD4J24A	SOD4J24CA	SOD-123FL	24.0	1	26.70	29.50	10.28	38.9	400
SOD4J26A	SOD4J26CA	SOD-123FL	26.0	1	28.90	31.90	9.50	42.1	400
SOD4J28A	SOD4J28CA	SOD-123FL	28.0	1	31.10	34.40	8.81	45.4	400
SOD4J30A	SOD4J30CA	SOD-123FL	30.0	1	33.30	36.80	8.26	48.4	400
SOD4J33A	SOD4J33CA	SOD-123FL	33.0	1	36.70	40.60	7.50	53.3	400
SOD4J36A	SOD4J36CA	SOD-123FL	36.0	1	40.00	44.20	6.88	58.1	400
SOD4J40A	SOD4J40CA	SOD-123FL	40.0	1	44.40	49.10	6.20	64.5	400
SOD4J43A	SOD4J43CA	SOD-123FL	43.0	1	47.80	52.80	5.76	69.4	400

Power Transient Voltage Suppressors

Part Number		Package	V _{RWM} (V)	I _R max(uA)	V _{BR} min(V)	V _{BR} max(V)	I _{PP} (A)	V _C max(V)	P _{PP} (W)
SOD4J45A	SOD4J45CA	SOD-123FL	45.0	1	50.00	55.30	5.50	72.7	400
SOD4J48A	SOD4J48CA	SOD-123FL	48.0	1	53.30	58.90	5.17	77.4	400
SOD4J51A	SOD4J51CA	SOD-123FL	51.0	1	56.70	62.70	4.85	82.4	400
SOD4J54A	SOD4J54CA	SOD-123FL	54.0	1	60.00	66.30	4.59	87.1	400
SOD4J58A	SOD4J58CA	SOD-123FL	58.0	1	64.40	71.20	4.27	93.6	400
SOD4J60A	SOD4J60CA	SOD-123FL	60.0	1	66.70	73.70	4.13	96.8	400
SOD4J64A	SOD4J64CA	SOD-123FL	64.0	1	71.10	78.60	3.88	103.0	400
SOD4J70A	SOD4J70CA	SOD-123FL	70.0	1	77.80	86.00	3.54	113.0	400
SOD4J75A	SOD4J75CA	SOD-123FL	75.0	1	83.30	92.10	3.31	121.0	400
SOD4J78A	SOD4J78CA	SOD-123FL	78.0	1	86.70	95.80	3.17	126.0	400
SOD4J85A	SOD4J85CA	SOD-123FL	85.0	1	94.40	104.00	2.92	137.0	400
SOD4J90A	SOD4J90CA	SOD-123FL	90.0	1	100.00	111.00	2.74	146.0	400
SOD4J100A	SOD4J100CA	SOD-123FL	100.0	1	111.00	123.00	2.47	162.0	400
SOD4J110A	SOD4J110CA	SOD-123FL	110.0	1	122.00	135.00	2.26	177.0	400
SOD4J120A	SOD4J120CA	SOD-123FL	120.0	1	133.00	147.00	2.07	193.0	400
SOD4J130A	SOD4J130CA	SOD-123FL	130.0	1	144.00	159.00	1.91	209.0	400
SOD4J140A	SOD4J140CA	SOD-123FL	140.0	1	155.00	171.00	1.76	226.8	400
SOD4J150A	SOD4J150CA	SOD-123FL	150.0	1	167.00	185.00	1.65	243.0	400
SOD4J160A	SOD4J160CA	SOD-123FL	160.0	1	178.00	197.00	1.54	259.0	400
SOD4J170A	SOD4J170CA	SOD-123FL	170.0	1	189.00	209.00	1.45	275.0	400
SMAJ5.0A	SMAJ5.0CA	SMA	5.0	800	6.4	7.07	43.48	9.2	400
SMAJ6.0A	SMAJ6.0CA	SMA	6.0	800	6.67	7.37	38.83	10.3	400
SMAJ6.5A	SMAJ6.5CA	SMA	6.5	500	7.22	7.98	35.71	11.2	400
SMAJ7.0A	SMAJ7.0CA	SMA	7.0	200	7.78	8.60	33.33	12.0	400
SMAJ7.5A	SMAJ7.5CA	SMA	7.5	100	8.33	9.21	31.01	12.9	400
SMAJ8.0A	SMAJ8.0CA	SMA	8.0	50	8.89	9.83	29.41	13.6	400
SMAJ8.5A	SMAJ8.5CA	SMA	8.5	10	9.44	10.40	27.78	14.4	400
SMAJ9.0A	SMAJ9.0CA	SMA	9.0	5	10.00	11.10	25.97	15.4	400
SMAJ10A	SMAJ10CA	SMA	10.0	5	11.10	12.30	23.53	17.0	400
SMAJ11A	SMAJ11CA	SMA	11.0	1	12.20	13.50	21.98	18.2	400
SMAJ12A	SMAJ12CA	SMA	12.0	1	13.30	14.70	20.10	19.9	400
SMAJ13A	SMAJ13CA	SMA	13.0	1	14.40	15.90	18.60	21.5	400
SMAJ14A	SMAJ14CA	SMA	14.0	1	15.60	17.20	17.24	23.2	400
SMAJ15A	SMAJ15CA	SMA	15.0	1	16.70	18.50	16.39	24.4	400
SMAJ16A	SMAJ16CA	SMA	16.0	1	17.80	19.70	15.38	26.0	400
SMAJ17A	SMAJ17CA	SMA	17.0	1	18.90	20.90	14.49	27.6	400
SMAJ18A	SMAJ18CA	SMA	18.0	1	20.00	22.10	13.70	29.2	400
SMAJ19A	SMAJ19CA	SMA	19.0	1	21.10	23.30	13.00	30.8	400
SMAJ20A	SMAJ20CA	SMA	20.0	1	22.20	24.50	12.35	32.4	400
SMAJ22A	SMAJ22CA	SMA	22.0	1	24.40	26.90	11.27	35.5	400

Power Transient Voltage Suppressors

Part Number		Package	V _{RWM} (V)	I _R max(μA)	V _{BR} min(V)	V _{BR} max(V)	I _{PP} (A)	V _C max(V)	P _{PP} (W)
SMAJ24A	SMAJ24CA	SMA	24.0	1	26.70	29.50	10.28	38.9	400
SMAJ26A	SMAJ26CA	SMA	26.0	1	28.90	31.90	9.50	42.1	400
SMAJ28A	SMAJ28CA	SMA	28.0	1	31.10	34.40	8.81	45.4	400
SMAJ30A	SMAJ30CA	SMA	30.0	1	33.30	36.80	8.26	48.4	400
SMAJ33A	SMAJ33CA	SMA	33.0	1	36.70	40.60	7.50	53.3	400
SMAJ36A	SMAJ36CA	SMA	36.0	1	40.00	44.20	6.88	58.1	400
SMAJ40A	SMAJ40CA	SMA	40.0	1	44.40	49.10	6.20	64.5	400
SMAJ43A	SMAJ43CA	SMA	43.0	1	47.80	52.80	5.76	69.4	400
SMAJ45A	SMAJ45CA	SMA	45.0	1	50.00	55.30	5.50	72.7	400
SMAJ48A	SMAJ48CA	SMA	48.0	1	53.30	58.90	5.17	77.4	400
SMAJ51A	SMAJ51CA	SMA	51.0	1	56.70	62.70	4.85	82.4	400
SMAJ54A	SMAJ54CA	SMA	54.0	1	60.00	66.30	4.59	87.1	400
SMAJ58A	SMAJ58CA	SMA	58.0	1	64.40	71.20	4.27	93.6	400
SMAJ60A	SMAJ60CA	SMA	60.0	1	66.70	73.70	4.13	96.8	400
SMAJ64A	SMAJ64CA	SMA	64.0	1	71.10	78.60	3.88	103.0	400
SMAJ70A	SMAJ70CA	SMA	70.0	1	77.80	86.00	3.54	113.0	400
SMAJ75A	SMAJ75CA	SMA	75.0	1	83.30	92.10	3.31	121.0	400
SMAJ78A	SMAJ78CA	SMA	78.0	1	86.70	95.80	3.17	126.0	400
SMAJ85A	SMAJ85CA	SMA	85.0	1	94.40	104.00	2.92	137.0	400
SMAJ90A	SMAJ90CA	SMA	90.0	1	100.00	111.00	2.74	146.0	400
SMAJ100A	SMAJ100CA	SMA	100.0	1	111.00	123.00	2.47	162.0	400
SMAJ110A	SMAJ110CA	SMA	110.0	1	122.00	135.00	2.26	177.0	400
SMAJ120A	SMAJ120CA	SMA	120.0	1	133.00	147.00	2.07	193.0	400
SMAJ130A	SMAJ130CA	SMA	130.0	1	144.00	159.00	1.91	209.0	400
SMAJ140A	SMAJ140CA	SMA	140.0	1	155.00	171.00	1.76	226.8	400
SMAJ150A	SMAJ150CA	SMA	150.0	1	167.00	185.00	1.65	243.0	400
SMAJ160A	SMAJ160CA	SMA	160.0	1	178.00	197.00	1.54	259.0	400
SMAJ170A	SMAJ170CA	SMA	170.0	1	189.00	209.00	1.45	275.0	400
SMAJ180A	SMAJ180CA	SMA	180.0	1	200.00	220.00	1.37	291.6	400
SMAJ190A	SMAJ190CA	SMA	190.0	1	211.00	232.00	1.30	307.8	400
SMAJ200A	SMAJ200CA	SMA	200.0	1	224.00	247.00	1.23	324.0	400
SMAJ220A	SMAJ220CA	SMA	220.0	1	246.00	272.00	1.12	356.0	400
SMAJ250A	SMAJ250CA	SMA	250.0	1	279.00	309.00	0.99	405.0	400
SMAJ300A	SMAJ300CA	SMA	300.0	1	335.00	371.00	0.82	486.0	400
SMAJ350A	SMAJ350CA	SMA	350.0	1	391.00	432.00	0.71	567.0	400
SMAJ400A	SMAJ400CA	SMA	400.0	1	447.00	494.00	0.62	648.0	400
SMAJ440A	SMAJ440CA	SMA	440.0	1	492.00	543.00	0.56	713.0	400
P4SMA6.8A	P4SMA6.8CA	SMA	5.80	1000	6.45	7.14	39.0	10.5	400

Power Transient Voltage Suppressors

Part Number		Package	V _{RWM} (V)	I _R max(uA)	V _{BR} min(V)	V _{BR} max(V)	I _{PP} (A)	V _C max(V)	P _{PP} (W)
P4SMA7.5A	P4SMA7.5CA	SMA	6.40	500	7.13	7.88	36.3	11.3	400
P4SMA8.2A	P4SMA8.2CA	SMA	7.02	200	7.79	8.61	33.9	12.1	400
P4SMA9.1A	P4SMA9.1CA	SMA	7.78	50	8.65	9.55	30.6	13.4	400
P4SMA10A	P4SMA10CA	SMA	8.55	10	9.50	10.50	28.3	14.5	400
P4SMA11A	P4SMA11CA	SMA	9.40	5	10.50	11.60	26.3	15.6	400
P4SMA12A	P4SMA12CA	SMA	10.20	5	11.40	12.60	24.6	16.7	400
P4SMA13A	P4SMA13CA	SMA	11.10	1	12.40	13.70	22.5	18.2	400
P4SMA15A	P4SMA15CA	SMA	12.80	1	14.30	15.80	19.3	21.2	400
P4SMA16A	P4SMA16CA	SMA	13.60	1	15.20	16.80	18.2	22.5	400
P4SMA18A	P4SMA18CA	SMA	15.30	1	17.10	18.90	16.1	25.2	400
P4SMA20A	P4SMA20CA	SMA	17.10	1	19.00	21.00	14.8	27.7	400
P4SMA22A	P4SMA22CA	SMA	18.80	1	20.90	23.10	13.4	30.6	400
P4SMA24A	P4SMA24CA	SMA	20.50	1	22.80	25.20	12.3	33.2	400
P4SMA27A	P4SMA27CA	SMA	23.10	1	25.70	28.40	10.9	37.5	400
P4SMA30A	P4SMA30CA	SMA	25.60	1	28.50	31.50	9.9	41.4	400
P4SMA33A	P4SMA33CA	SMA	28.20	1	31.40	34.70	9.0	45.7	400
P4SMA36A	P4SMA36CA	SMA	30.80	1	34.20	37.80	8.2	49.9	400
P4SMA39A	P4SMA39CA	SMA	33.30	1	37.10	41.00	7.6	53.9	400
P4SMA43A	P4SMA43CA	SMA	36.80	1	40.90	45.20	6.9	59.3	400
P4SMA47A	P4SMA47CA	SMA	40.20	1	44.70	49.40	6.3	64.8	400
P4SMA51A	P4SMA51CA	SMA	43.60	1	48.50	53.60	5.8	70.1	400
P4SMA56A	P4SMA56CA	SMA	47.80	1	53.20	58.80	5.3	77.0	400
P4SMA62A	P4SMA62CA	SMA	53.00	1	58.90	65.10	4.8	85.0	400
P4SMA68A	P4SMA68CA	SMA	58.10	1	64.60	71.40	4.5	92.0	400
P4SMA75A	P4SMA75CA	SMA	64.10	1	71.30	78.80	4.0	103.0	400
P4SMA82A	P4SMA82CA	SMA	70.10	1	77.90	86.10	3.6	113.0	400
P4SMA91A	P4SMA91CA	SMA	77.80	1	86.50	95.50	3.3	125.0	400
P4SMA100A	P4SMA100CA	SMA	85.50	1	95.00	105.00	3.0	137.0	400
P4SMA110A	P4SMA110CA	SMA	94.00	1	105.00	116.00	2.7	152.0	400
P4SMA120A	P4SMA120CA	SMA	102.00	1	114.00	126.00	2.5	165.0	400
P4SMA130A	P4SMA130CA	SMA	111.00	1	124.00	137.00	2.3	179.0	400
P4SMA150A	P4SMA150CA	SMA	128.00	1	143.00	158.00	2.0	207.0	400
P4SMA160A	P4SMA160CA	SMA	136.00	1	152.00	168.00	1.9	219.0	400
P4SMA170A	P4SMA170CA	SMA	145.00	1	162.00	179.00	1.8	234.0	400
P4SMA180A	P4SMA180CA	SMA	154.00	1	171.00	189.00	1.7	246.0	400
P4SMA200A	P4SMA200CA	SMA	171.00	1	190.00	210.00	1.5	274.0	400
P4SMA220A	P4SMA220CA	SMA	185.00	1	209.00	231.00	1.3	328.0	400
P4SMA250A	P4SMA250CA	SMA	214.00	1	237.00	263.00	1.2	344.00	400

Power Transient Voltage Suppressors

Part Number		Package	V _{RWM} (V)	I _R max(μA)	V _{BR} min(V)	V _{BR} max(V)	I _{PP} (A)	V _C max(V)	P _{PP} (W)
P4SMA300A	P4SMA300CA	SMA	256.00	1	285.00	315.00	1.0	414.00	400
P4SMA350A	P4SMA350CA	SMA	300.00	1	332.00	368.00	0.9	482.00	400
P4SMA400A	P4SMA400CA	SMA	342.00	1	380.00	420.00	0.8	548.00	400
P4SMA440A	P4SMA440CA	SMA	376.00	1	418.00	462.00	0.7	602.00	400
P4SMA480A	P4SMA480CA	SMA	408.00	1	456.00	504.00	0.6	658.00	400
P4SMA510A	P4SMA510CA	SMA	434.00	1	485.00	535.00	0.6	698.00	400
P4SMA530A	P4SMA530CA	SMA	450.00	1	503.50	556.50	0.6	725.00	400
P4SMA540A	P4SMA540CA	SMA	459.00	1	513.00	567.00	0.5	740.00	400
P4SMA550A	P4SMA550CA	SMA	467.00	1	522.50	557.50	0.5	760.00	400
SMA6J5.0A	SMA6J5.0CA	SMA	5.0	800	6.4	7.00	65.22	9.2	600
SMA6J6.0A	SMA6J6.0CA	SMA	6.0	800	6.7	7.37	58.25	10.3	600
SMA6J6.5A	SMA6J6.5CA	SMA	6.5	500	7.2	7.98	53.57	11.2	600
SMA6J7.0A	SMA6J7.0CA	SMA	7.0	200	7.8	8.60	50.00	12.0	600
SMA6J7.5A	SMA6J7.5CA	SMA	7.5	100	8.3	9.21	46.51	12.9	600
SMA6J8.0A	SMA6J8.0CA	SMA	8.0	50	8.9	9.83	44.12	13.6	600
SMA6J8.5A	SMA6J8.5CA	SMA	8.5	10	9.4	10.40	41.67	14.4	600
SMA6J9.0A	SMA6J9.0CA	SMA	9.0	5	10.0	11.10	38.96	15.4	600
SMA6J10A	SMA6J10CA	SMA	10.0	5	11.1	12.30	35.29	17.0	600
SMA6J11A	SMA6J11CA	SMA	11.0	1	12.2	13.50	32.97	18.2	600
SMA6J12A	SMA6J12CA	SMA	12.0	1	13.3	14.70	30.15	19.9	600
SMA6J13A	SMA6J13CA	SMA	13.0	1	14.4	15.90	27.91	21.5	600
SMA6J14A	SMA6J14CA	SMA	14.0	1	15.6	17.20	25.86	23.2	600
SMA6J15A	SMA6J15CA	SMA	15.0	1	16.7	18.50	24.59	24.4	600
SMA6J16A	SMA6J16CA	SMA	16.0	1	17.8	19.70	23.08	26.0	600
SMA6J17A	SMA6J17CA	SMA	17.0	1	18.9	20.90	21.74	27.6	600
SMA6J18A	SMA6J18CA	SMA	18.0	1	20.0	22.10	20.55	29.2	600
SMA6J19A	SMA6J19CA	SMA	19.0	1	21.1	23.30	19.49	30.8	600
SMA6J20A	SMA6J20CA	SMA	20.0	1	22.2	24.50	18.52	32.4	600
SMA6J22A	SMA6J22CA	SMA	22.0	1	24.4	26.90	16.90	35.5	600
SMA6J24A	SMA6J24CA	SMA	24.0	1	26.7	29.50	15.42	38.9	600
SMA6J26A	SMA6J26CA	SMA	26.0	1	28.9	31.90	14.25	42.1	600
SMA6J28A	SMA6J28CA	SMA	28.0	1	31.1	34.40	13.22	45.4	600
SMA6J30A	SMA6J30CA	SMA	30.0	1	33.3	36.80	12.40	48.4	600
SMA6J33A	SMA6J33CA	SMA	33.0	1	36.7	40.60	11.26	53.3	600
SMA6J36A	SMA6J36CA	SMA	36.0	1	40.0	44.20	10.33	58.1	600
SMA6J40A	SMA6J40CA	SMA	40.0	1	44.4	49.10	9.30	64.5	600
SMA6J43A	SMA6J43CA	SMA	43.0	1	47.8	52.80	8.65	69.4	600
SMA6J45A	SMA6J45CA	SMA	45.0	1	50.0	55.30	8.25	72.7	600
SMA6J48A	SMA6J48CA	SMA	48.0	1	53.3	58.90	7.75	77.4	600
SMA6J51A	SMA6J51CA	SMA	51.0	1	56.7	62.70	7.28	82.4	600

Power Transient Voltage Suppressors

Part Number		Package	V _{RWM} (V)	I _R max(uA)	V _{BR} min(V)	V _{BR} max(V)	I _{PP} (A)	V _C max(V)	P _{PP} (W)
SMA6J54A	SMA6J54CA	SMA	54.0	1	60.0	66.30	6.89	87.1	600
SMA6J58A	SMA6J58CA	SMA	58.0	1	64.4	71.20	6.41	93.6	600
SMA6J60A	SMA6J60CA	SMA	60.0	1	66.7	73.70	6.20	96.8	600
SMA6J64A	SMA6J64CA	SMA	64.0	1	71.1	78.60	5.83	103.0	600
SMA6J70A	SMA6J70CA	SMA	70.0	1	77.8	86.00	5.31	113.0	600
SMA6J75A	SMA6J75CA	SMA	75.0	1	83.3	92.10	4.96	121.0	600
SMA6J78A	SMA6J78CA	SMA	78.0	1	86.7	95.80	4.76	126.0	600
SMA6J85A	SMA6J85CA	SMA	85.0	1	94.4	104.00	4.38	137.0	600
SMA6J90A	SMA6J90CA	SMA	90.0	1	100.0	111.00	4.11	146.0	600
SMA6J100A	SMA6J100CA	SMA	100.0	1	111.0	123.00	3.70	162.0	600
SMA6J110A	SMA6J110CA	SMA	110.0	1	122.0	135.00	3.39	177.0	600
SMA6J120A	SMA6J120CA	SMA	120.0	1	133.0	147.00	3.11	193.0	600
SMA6J130A	SMA6J130CA	SMA	130.0	1	144.0	159.00	2.87	209.0	600
SMA6J140A	SMA6J140CA	SMA	140.0	1	155.0	171.00	2.65	226.8	600
SMA6J150A	SMA6J150CA	SMA	150.0	1	167.0	185.00	2.47	243.0	600
SMA6J160A	SMA6J160CA	SMA	160.0	1	178.0	197.00	2.32	259.0	600
SMA6J170A	SMA6J170CA	SMA	170.0	1	189.0	209.00	2.18	275.0	600
SMA6J180A	SMA6J180CA	SMA	180.0	1	200.0	220.00	2.06	291.6	600
SMBJ5.0A	SMBJ5.0CA	SMB	5.0	800	6.4	7.00	65.22	9.2	600
SMBJ6.0A	SMBJ6.0CA	SMB	6.0	800	6.7	7.37	58.25	10.3	600
SMBJ6.5A	SMBJ6.5CA	SMB	6.5	500	7.2	7.98	53.57	11.2	600
SMBJ7.0A	SMBJ7.0CA	SMB	7.0	200	7.8	8.60	50.00	12.0	600
SMBJ7.5A	SMBJ7.5CA	SMB	7.5	100	8.3	9.21	46.51	12.9	600
SMBJ8.0A	SMBJ8.0CA	SMB	8.0	50	8.9	9.83	44.12	13.6	600
SMBJ8.5A	SMBJ8.5CA	SMB	8.5	10	9.4	10.40	41.67	14.4	600
SMBJ9.0A	SMBJ9.0CA	SMB	9.0	5	10.0	11.10	38.96	15.4	600
SMBJ10A	SMBJ10CA	SMB	10.0	5	11.1	12.30	35.29	17.0	600
SMBJ11A	SMBJ11CA	SMB	11.0	1	12.2	13.50	32.97	18.2	600
SMBJ12A	SMBJ12CA	SMB	12.0	1	13.3	14.70	30.15	19.9	600
SMBJ13A	SMBJ13CA	SMB	13.0	1	14.4	15.90	27.91	21.5	600
SMBJ14A	SMBJ14CA	SMB	14.0	1	15.6	17.20	25.86	23.2	600
SMBJ15A	SMBJ15CA	SMB	15.0	1	16.7	18.50	24.59	24.4	600
SMBJ16A	SMBJ16CA	SMB	16.0	1	17.8	19.70	23.08	26.0	600
SMBJ17A	SMBJ17CA	SMB	17.0	1	18.9	20.90	21.74	27.6	600
SMBJ18A	SMBJ18CA	SMB	18.0	1	20.0	22.10	20.55	29.2	600
SMBJ19A	SMBJ19CA	SMB	19.0	1	21.1	23.30	19.49	30.8	600
SMBJ20A	SMBJ20CA	SMB	20.0	1	22.2	24.50	18.52	32.4	600
SMBJ22A	SMBJ22CA	SMB	22.0	1	24.4	26.90	16.90	35.5	600

Power Transient Voltage Suppressors

Part Number		Package	V _{RWM} (V)	I _R max(uA)	V _{BR} min(V)	V _{BR} max(V)	I _{PP} (A)	V _C max(V)	P _{PP} (W)
SMBJ24A	SMBJ24CA	SMB	24.0	1	26.7	29.50	15.42	38.9	600
SMBJ26A	SMBJ26CA	SMB	26.0	1	28.9	31.90	14.25	42.1	600
SMBJ28A	SMBJ28CA	SMB	28.0	1	31.1	34.40	13.22	45.4	600
SMBJ30A	SMBJ30CA	SMB	30.0	1	33.3	36.80	12.40	48.4	600
SMBJ33A	SMBJ33CA	SMB	33.0	1	36.7	40.60	11.26	53.3	600
SMBJ36A	SMBJ36CA	SMB	36.0	1	40.0	44.20	10.33	58.1	600
SMBJ40A	SMBJ40CA	SMB	40.0	1	44.4	49.10	9.30	64.5	600
SMBJ43A	SMBJ43CA	SMB	43.0	1	47.8	52.80	8.65	69.4	600
SMBJ45A	SMBJ45CA	SMB	45.0	1	50.0	55.30	8.25	72.7	600
SMBJ48A	SMBJ48CA	SMB	48.0	1	53.3	58.90	7.75	77.4	600
SMBJ51A	SMBJ51CA	SMB	51.0	1	56.7	62.70	7.28	82.4	600
SMBJ54A	SMBJ54CA	SMB	54.0	1	60.0	66.30	6.89	87.1	600
SMBJ58A	SMBJ58CA	SMB	58.0	1	64.4	71.20	6.41	93.6	600
SMBJ60A	SMBJ60CA	SMB	60.0	1	66.7	73.70	6.20	96.8	600
SMBJ64A	SMBJ64CA	SMB	64.0	1	71.1	78.60	5.83	103.0	600
SMBJ70A	SMBJ70CA	SMB	70.0	1	77.8	86.00	5.31	113.0	600
SMBJ75A	SMBJ75CA	SMB	75.0	1	83.3	92.10	4.96	121.0	600
SMBJ78A	SMBJ78CA	SMB	78.0	1	86.7	95.80	4.76	126.0	600
SMBJ85A	SMBJ85CA	SMB	85.0	1	94.4	104.00	4.38	137.0	600
SMBJ90A	SMBJ90CA	SMB	90.0	1	100.0	111.00	4.11	146.0	600
SMBJ100A	SMBJ100CA	SMB	100.0	1	111.0	123.00	3.70	162.0	600
SMBJ110A	SMBJ110CA	SMB	110.0	1	122.0	135.00	3.39	177.0	600
SMBJ120A	SMBJ120CA	SMB	120.0	1	133.0	147.00	3.11	193.0	600
SMBJ130A	SMBJ130CA	SMB	130.0	1	144.0	159.00	2.87	209.0	600
SMBJ140A	SMBJ140CA	SMB	140.0	1	155.0	171.00	2.65	226.8	600
SMBJ150A	SMBJ150CA	SMB	150.0	1	167.0	185.00	2.47	243.0	600
SMBJ160A	SMBJ160CA	SMB	160.0	1	178.0	197.00	2.32	259.0	600
SMBJ170A	SMBJ170CA	SMB	170.0	1	189.0	209.00	2.18	275.0	600
SMBJ180A	SMBJ180CA	SMB	180.0	1	200.0	220.00	2.06	291.6	600
SMBJ190A	SMBJ190CA	SMB	190.0	1	211.0	232.00	1.95	307.8	600
SMBJ200A	SMBJ200CA	SMB	200.0	1	224.0	247.00	1.85	324.0	600
SMBJ220A	SMBJ220CA	SMB	220.0	1	246.0	272.00	1.69	356.0	600
SMBJ250A	SMBJ250CA	SMB	250.0	1	279.0	309.00	1.48	405.0	600
SMBJ300A	SMBJ300CA	SMB	300.0	1	335.0	371.00	1.23	486.0	600
SMBJ350A	SMBJ350CA	SMB	350.0	1	391.0	432.00	1.06	567.0	600
SMBJ400A	SMBJ400CA	SMB	400.0	1	447.0	494.00	0.93	648.0	600
SMBJ440A	SMBJ440CA	SMB	440.0	1	492.0	543.00	0.84	713.0	600
P6SMB6,8A	P6SMB6,8CA	SMB	5.80	1000	6.45	7.14	57.1	10.5	600

Power Transient Voltage Suppressors

Part Number		Package	V _{RWM} (V)	I _R max(μA)	V _{BR} min(V)	V _{BR} max(V)	I _{PP} (A)	V _C max(V)	P _{PP} (W)
P6SMB7.5A	P6SMB7.5CA	SMB	6.40	500	7.13	7.88	53.1	11.3	600
P6SMB10A	P6SMB10CA	SMB	8.55	10	9.50	10.5	41.4	14.5	600
P6SMB12A	P6SMB12CA	SMB	10.2	5.0	11.4	12.6	35.9	16.7	600
P6SMB15A	P6SMB15CA	SMB	12.8	1.0	14.3	15.8	28.3	21.2	600
P6SMB18A	P6SMB18CA	SMB	15.3	1.0	17.1	18.9	23.8	25.2	600
P6SMB22A	P6SMB22CA	SMB	18.8	1.0	20.9	23.1	19.6	30.6	600
P6SMB24A	P6SMB24CA	SMB	20.5	1.0	22.8	25.2	18.1	33.2	600
P6SMB27A	P6SMB27CA	SMB	23.1	1.0	25.7	28.4	16.0	37.5	600
P6SMB30A	P6SMB30CA	SMB	25.6	1.0	28.5	31.5	14.5	41.4	600
P6SMB33A	P6SMB33CA	SMB	28.2	1.0	31.4	34.7	13.1	45.7	600
P6SMB36A	P6SMB36CA	SMB	30.8	1.0	34.2	37.8	12.0	49.9	600
P6SMB39A	P6SMB39CA	SMB	33.3	1.0	37.1	41.0	11.1	53.9	600
P6SMB56A	P6SMB56CA	SMB	47.8	1.0	53.2	58.8	7.8	77.0	600
P6SMB62A	P6SMB62CA	SMB	53.0	1.0	58.9	65.1	7.1	85.0	600
P6SMB68A	P6SMB68CA	SMB	58.1	1.0	64.6	71.4	6.5	92.0	600
P6SMB75A	P6SMB75CA	SMB	64.1	1.0	71.3	78.8	5.8	103	600
P6SMB82A	P6SMB82CA	SMB	70.1	1.0	77.9	86.1	5.3	113	600
P6SMB91A	P6SMB91CA	SMB	77.8	1.0	86.5	95.5	4.8	125	600
P6SMB100A	P6SMB100CA	SMB	85.5	1.0	95.0	105	4.4	137	600
P6SMB110A	P6SMB110CA	SMB	94.0	1.0	105	116	3.9	152	600
P6SMB120A	P6SMB120CA	SMB	102	1.0	114	126	3.6	165	600
P6SMB130A	P6SMB130CA	SMB	111	1.0	124	137	3.4	179	600
P6SMB150A	P6SMB150CA	SMB	128	1.0	143	158	2.9	207	600
P6SMB160A	P6SMB160CA	SMB	136	1.0	152	168	2.7	219	600
P6SMB170A	P6SMB170CA	SMB	145	1.0	162	179	2.6	234	600
P6SMB180A	P6SMB180CA	SMB	154	1.0	171	189	2.4	246	600
P6SMB200A	P6SMB200CA	SMB	171	1.0	190	210	2.2	274	600
P6SMB220A	P6SMB220CA	SMB	185	1.0	209	231	1.9	328	600
P6SMB250A	P6SMB250CA	SMB	214	1.0	237	263	1.7	344	600
P6SMB300A	P6SMB300CA	SMB	256	1.0	285	315	1.4	414	600
P6SMB350A	P6SMB350CA	SMB	300	1.0	333	368	1.2	482	600
P6SMB400A	P6SMB400CA	SMB	342	1.0	380	420	1.1	548	600
P6SMB440A	P6SMB440CA	SMB	376	1.0	418	462	1.0	602	600
1.0SMBJ5.0A	1.0SMBJ5.0CA	SMB	5.0	800	6.4	7.00	108.7	9.2	1000
1.0SMBJ6.0A	1.0SMBJ6.0CA	SMB	6.0	800	6.7	7.37	97.09	10.3	1000
1.0SMBJ6.5A	1.0SMBJ6.5CA	SMB	6.5	500	7.2	7.98	89.29	11.2	1000
1.0SMBJ7.0A	1.0SMBJ7.0CA	SMB	7.0	200	7.8	8.60	83.33	12.0	1000
1.0SMBJ7.5A	1.0SMBJ7.5CA	SMB	7.5	100	8.3	9.21	77.52	12.9	1000
1.0SMBJ8.0A	1.0SMBJ8.0CA	SMB	8.0	50	8.9	9.83	73.53	13.6	1000
1.0SMBJ8.5A	1.0SMBJ8.5CA	SMB	8.5	10	9.4	10.40	69.44	14.4	1000

Power Transient Voltage Suppressors

Part Number		Package	V _{RWM} (V)	I _R max(uA)	V _{BR} min(V)	V _{BR} max(V)	I _{PP} (A)	V _C max(V)	P _{PP} (W)
1.0SMBJ9.0A	1.0SMBJ9.0CA	SMB	9.0	5	10.0	11.10	64.94	15.4	1000
1.0SMBJ10A	1.0SMBJ10CA	SMB	10.0	5	11.1	12.30	58.82	17.0	1000
1.0SMBJ11A	1.0SMBJ11CA	SMB	11.0	1	12.2	13.50	54.95	18.2	1000
1.0SMBJ12A	1.0SMBJ12CA	SMB	12.0	1	13.3	14.70	50.25	19.9	1000
1.0SMBJ13A	1.0SMBJ13CA	SMB	13.0	1	14.4	15.90	46.51	21.5	1000
1.0SMBJ14A	1.0SMBJ14CA	SMB	14.0	1	15.6	17.20	43.10	23.2	1000
1.0SMBJ15A	1.0SMBJ15CA	SMB	15.0	1	16.7	18.50	40.98	24.4	1000
1.0SMBJ16A	1.0SMBJ16CA	SMB	16.0	1	17.8	19.70	38.46	26.0	1000
1.0SMBJ17A	1.0SMBJ17CA	SMB	17.0	1	18.9	20.90	36.23	27.6	1000
1.0SMBJ18A	1.0SMBJ18CA	SMB	18.0	1	20.0	22.10	34.25	29.2	1000
1.0SMBJ19A	1.0SMBJ19CA	SMB	19.0	1	21.1	23.30	32.47	30.8	1000
1.0SMBJ20A	1.0SMBJ20CA	SMB	20.0	1	22.2	24.50	30.86	32.4	1000
1.0SMBJ22A	1.0SMBJ22CA	SMB	22.0	1	24.4	26.90	28.17	35.5	1000
1.0SMBJ24A	1.0SMBJ24CA	SMB	24.0	1	26.7	29.50	25.71	38.9	1000
1.0SMBJ26A	1.0SMBJ26CA	SMB	26.0	1	28.9	31.90	23.75	42.1	1000
1.0SMBJ28A	1.0SMBJ28CA	SMB	28.0	1	31.1	34.40	22.03	45.4	1000
1.0SMBJ30A	1.0SMBJ30CA	SMB	30.0	1	33.3	36.80	20.66	48.4	1000
1.0SMBJ33A	1.0SMBJ33CA	SMB	33.0	1	36.7	40.60	18.76	53.3	1000
1.0SMBJ36A	1.0SMBJ36CA	SMB	36.0	1	40.0	44.20	17.21	58.1	1000
1.0SMBJ40A	1.0SMBJ40CA	SMB	40.0	1	44.4	49.10	15.50	64.5	1000
1.0SMBJ43A	1.0SMBJ43CA	SMB	43.0	1	47.8	52.80	14.41	69.4	1000
1.0SMBJ45A	1.0SMBJ45CA	SMB	45.0	1	50.0	55.30	13.76	72.7	1000
1.0SMBJ48A	1.0SMBJ48CA	SMB	48.0	1	53.3	58.90	12.92	77.4	1000
1.0SMBJ51A	1.0SMBJ51CA	SMB	51.0	1	56.7	62.70	12.14	82.4	1000
1.0SMBJ54A	1.0SMBJ54CA	SMB	54.0	1	60.0	66.30	11.48	87.1	1000
1.0SMBJ58A	1.0SMBJ58CA	SMB	58.0	1	64.4	71.20	10.68	93.6	1000
1.0SMBJ60A	1.0SMBJ60CA	SMB	60.0	1	66.7	73.70	10.33	96.8	1000
1.0SMBJ64A	1.0SMBJ64CA	SMB	64.0	1	71.1	78.60	9.71	103.0	1000
1.0SMBJ70A	1.0SMBJ70CA	SMB	70.0	1	77.8	86.00	8.85	113.0	1000
1.0SMBJ75A	1.0SMBJ75CA	SMB	75.0	1	83.3	92.10	8.26	121.0	1000
1.0SMBJ78A	1.0SMBJ78CA	SMB	78.0	1	86.7	95.80	7.94	126.0	1000
1.0SMBJ85A	1.0SMBJ85CA	SMB	85.0	1	94.4	104.00	7.30	137.0	1000
1.0SMBJ90A	1.0SMBJ90CA	SMB	90.0	1	100.0	111.00	6.85	146.0	1000
1.0SMBJ100A	1.0SMBJ100CA	SMB	100.0	1	111.0	123.00	6.17	162.0	1000
1.0SMBJ110A	1.0SMBJ110CA	SMB	110.0	1	122.0	135.00	5.65	177.0	1000
1.0SMBJ120A	1.0SMBJ120CA	SMB	120.0	1	133.0	147.00	5.18	193.0	1000
1.0SMBJ130A	1.0SMBJ130CA	SMB	130.0	1	144.0	159.00	4.79	209.0	1000
1.0SMBJ150A	1.0SMBJ150CA	SMB	150.0	1	167.0	185.00	4.12	243.0	1000

Power Transient Voltage Suppressors

Part Number		Package	V _{RWM} (V)	I _R max(uA)	V _{BR} min(V)	V _{BR} max(V)	I _{PP} (A)	V _C max(V)	P _{PP} (W)
1.0SMBJ160A	1.0SMBJ160CA	SMB	160.0	1	178.0	197.00	3.86	259.0	1000
1.0SMBJ170A	1.0SMBJ170CA	SMB	170.0	1	189.0	209.00	3.64	275.0	1000
1.5SMBJ5.0A	1.5SMBJ5.0CA	SMB	5.0	800	6.4	7.00	163.04	9.2	1500
1.5SMBJ6.0A	1.5SMBJ6.0CA	SMB	6.0	800	6.7	7.37	145.63	10.3	1500
1.5SMBJ6.5A	1.5SMBJ6.5CA	SMB	6.5	500	7.2	7.98	133.93	11.2	1500
1.5SMBJ7.0A	1.5SMBJ7.0CA	SMB	7.0	200	7.8	8.60	125.00	12.0	1500
1.5SMBJ7.5A	1.5SMBJ7.5CA	SMB	7.5	100	8.3	9.21	116.28	12.9	1500
1.5SMBJ8.0A	1.5SMBJ8.0CA	SMB	8.0	50	8.9	9.83	110.29	13.6	1500
1.5SMBJ8.5A	1.5SMBJ8.5CA	SMB	8.5	10	9.4	10.40	104.17	14.4	1500
1.5SMBJ9.0A	1.5SMBJ9.0CA	SMB	9.0	5	10.0	11.10	97.40	15.4	1500
1.5SMBJ10A	1.5SMBJ10CA	SMB	10.0	5	11.1	12.30	88.24	17.0	1500
1.5SMBJ11A	1.5SMBJ11CA	SMB	11.0	1	12.2	13.50	82.42	18.2	1500
1.5SMBJ12A	1.5SMBJ12CA	SMB	12.0	1	13.3	14.70	75.38	19.9	1500
1.5SMBJ13A	1.5SMBJ13CA	SMB	13.0	1	14.4	15.90	69.77	21.5	1500
1.5SMBJ14A	1.5SMBJ14CA	SMB	14.0	1	15.6	17.20	64.66	23.2	1500
1.5SMBJ15A	1.5SMBJ15CA	SMB	15.0	1	16.7	18.50	61.48	24.4	1500
1.5SMBJ16A	1.5SMBJ16CA	SMB	16.0	1	17.8	19.70	57.69	26.0	1500
1.5SMBJ17A	1.5SMBJ17CA	SMB	17.0	1	18.9	20.90	54.35	27.6	1500
1.5SMBJ18A	1.5SMBJ18CA	SMB	18.0	1	20.0	22.10	51.37	29.2	1500
1.5SMBJ19A	1.5SMBJ19CA	SMB	19.0	1	21.1	23.30	48.73	30.8	1500
1.5SMBJ20A	1.5SMBJ20CA	SMB	20.0	1	22.2	24.50	46.30	32.4	1500
1.5SMBJ22A	1.5SMBJ22CA	SMB	22.0	1	24.4	26.90	42.25	35.5	1500
1.5SMBJ24A	1.5SMBJ24CA	SMB	24.0	1	26.7	29.50	38.56	38.9	1500
1.5SMBJ26A	1.5SMBJ26CA	SMB	26.0	1	28.9	31.90	35.63	42.1	1500
1.5SMBJ28A	1.5SMBJ28CA	SMB	28.0	1	31.1	34.40	33.04	45.4	1500
1.5SMBJ30A	1.5SMBJ30CA	SMB	30.0	1	33.3	36.80	30.99	48.4	1500
1.5SMBJ33A	1.5SMBJ33CA	SMB	33.0	1	36.7	40.60	28.14	53.3	1500
1.5SMBJ36A	1.5SMBJ36CA	SMB	36.0	1	40.0	44.20	25.82	58.1	1500
1.5SMBJ40A	1.5SMBJ40CA	SMB	40.0	1	44.4	49.10	23.26	64.5	1500
1.5SMBJ43A	1.5SMBJ43CA	SMB	43.0	1	47.8	52.80	21.61	69.4	1500
1.5SMBJ45A	1.5SMBJ45CA	SMB	45.0	1	50.0	55.30	20.63	72.7	1500
1.5SMBJ48A	1.5SMBJ48CA	SMB	48.0	1	53.3	58.90	19.38	77.4	1500
1.5SMBJ51A	1.5SMBJ51CA	SMB	51.0	1	56.7	62.70	18.20	82.4	1500
1.5SMBJ54A	1.5SMBJ54CA	SMB	54.0	1	60.0	66.30	17.22	87.1	1500
1.5SMBJ58A	1.5SMBJ58CA	SMB	58.0	1	64.4	71.20	16.03	93.6	1500
1.5SMBJ60A	1.5SMBJ60CA	SMB	60.0	1	66.7	73.70	15.50	96.8	1500
1.5SMBJ64A	1.5SMBJ64CA	SMB	64.0	1	71.1	78.60	14.56	103.0	1500
1.5SMBJ70A	1.5SMBJ70CA	SMB	70.0	1	77.8	86.00	13.27	113.0	1500

Power Transient Voltage Suppressors

Part Number		Package	V _{RWM} (V)	I _R max(μA)	V _{BR} min(V)	V _{BR} max(V)	I _{PP} (A)	V _C max(V)	P _{PP} (W)
1.5SMBJ75A	1.5SMBJ75CA	SMB	75.0	1	83.3	92.10	12.40	121.0	1500
1.5SMBJ78A	1.5SMBJ78CA	SMB	78.0	1	86.7	95.80	11.90	126.0	1500
1.5SMBJ80A	1.5SMBJ80CA	SMB	80.0	1	88.8	97.60	11.57	129.6	1500
1.5SMBJ85A	1.5SMBJ85CA	SMB	85.0	1	94.4	104.00	10.95	137.0	1500
1.5SMBJ90A	1.5SMBJ90CA	SMB	90.0	1	100.0	111.00	10.27	146.0	1500
1.5SMBJ100A	1.5SMBJ100CA	SMB	100.0	1	111.0	123.00	9.26	162.0	1500
1.5SMBJ110A	1.5SMBJ110CA	SMB	110.0	1	122.0	135.00	8.47	177.0	1500
1.5SMBJ120A	1.5SMBJ120CA	SMB	120.0	1	133.0	147.00	7.77	193.0	1500
1.5SMBJ130A	1.5SMBJ130CA	SMB	130.0	1	144.0	159.00	7.18	209.0	1500
1.5SMBJ140A	1.5SMBJ140CA	SMB	140.0	1	155.0	171.00	6.61	226.8	1500
1.5SMBJ150A	1.5SMBJ150CA	SMB	150.0	1	167.0	185.00	6.17	243.0	1500
1.5SMBJ160A	1.5SMBJ160CA	SMB	160.0	1	178.0	197.00	5.79	259.0	1500
1.5SMBJ170A	1.5SMBJ170CA	SMB	170.0	1	189.0	209.00	5.45	275.0	1500
SMCJ5.0A	SMCJ5.0CA	SMC	5.0	800	6.4	7.00	163.04	9.2	1500
SMCJ6.0A	SMCJ6.0CA	SMC	6.0	800	6.7	7.37	145.63	10.3	1500
SMCJ6.5A	SMCJ6.5CA	SMC	6.5	500	7.2	7.98	133.93	11.2	1500
SMCJ7.0A	SMCJ7.0CA	SMC	7.0	200	7.8	8.60	125.00	12.0	1500
SMCJ7.5A	SMCJ7.5CA	SMC	7.5	100	8.3	9.21	116.28	12.9	1500
SMCJ8.0A	SMCJ8.0CA	SMC	8.0	50	8.9	9.83	110.29	13.6	1500
SMCJ8.5A	SMCJ8.5CA	SMC	8.5	20	9.4	10.40	104.17	14.4	1500
SMCJ9.0A	SMCJ9.0CA	SMC	9.0	10	10.0	11.10	97.40	15.4	1500
SMCJ10A	SMCJ10CA	SMC	10.0	5	11.1	12.30	88.24	17.0	1500
SMCJ11A	SMCJ11CA	SMC	11.0	1	12.2	13.50	82.42	18.2	1500
SMCJ12A	SMCJ12CA	SMC	12.0	1	13.3	14.70	75.38	19.9	1500
SMCJ13A	SMCJ13CA	SMC	13.0	1	14.4	15.90	69.77	21.5	1500
SMCJ14A	SMCJ14CA	SMC	14.0	1	15.6	17.20	64.66	23.2	1500
SMCJ15A	SMCJ15CA	SMC	15.0	1	16.7	18.50	61.48	24.4	1500
SMCJ16A	SMCJ16CA	SMC	16.0	1	17.8	19.70	57.69	26.0	1500
SMCJ17A	SMCJ17CA	SMC	17.0	1	18.9	20.90	54.35	27.6	1500
SMCJ18A	SMCJ18CA	SMC	18.0	1	20.0	22.10	51.37	29.2	1500
SMCJ19A	SMCJ19CA	SMC	19.0	1	21.1	23.30	48.73	30.8	1500
SMCJ20A	SMCJ20CA	SMC	20.0	1	22.2	24.50	46.30	32.4	1500
SMCJ22A	SMCJ22CA	SMC	22.0	1	24.4	26.90	42.25	35.5	1500
SMCJ24A	SMCJ24CA	SMC	24.0	1	26.7	29.50	38.56	38.9	1500
SMCJ26A	SMCJ26CA	SMC	26.0	1	28.9	31.90	35.63	42.1	1500
SMCJ28A	SMCJ28CA	SMC	28.0	1	31.1	34.40	33.04	45.4	1500
SMCJ30A	SMCJ30CA	SMC	30.0	1	33.3	36.80	30.99	48.4	1500
SMCJ33A	SMCJ33CA	SMC	33.0	1	36.7	40.60	28.14	53.3	1500
SMCJ36A	SMCJ36CA	SMC	36.0	1	40.0	44.20	25.82	58.1	1500
SMCJ40A	SMCJ40CA	SMC	40.0	1	44.4	49.10	23.26	64.5	1500

Power Transient Voltage Suppressors

Part Number		Package	V _{RWM} (V)	I _R max(uA)	V _{BR} min(V)	V _{BR} max(V)	I _{PP} (A)	V _C max(V)	P _{PP} (W)
SMCJ43A	SMCJ43CA	SMC	43.0	1	47.8	52.80	21.61	69.4	1500
SMCJ45A	SMCJ45CA	SMC	45.0	1	50.0	55.30	20.63	72.7	1500
SMCJ48A	SMCJ48CA	SMC	48.0	1	53.3	58.90	19.38	77.4	1500
SMCJ51A	SMCJ51CA	SMC	51.0	1	56.7	62.70	18.20	82.4	1500
SMCJ54A	SMCJ54CA	SMC	54.0	1	60.0	66.30	17.22	87.1	1500
SMCJ58A	SMCJ58CA	SMC	58.0	1	64.4	71.20	16.03	93.6	1500
SMCJ60A	SMCJ60CA	SMC	60.0	1	66.7	73.70	15.50	96.8	1500
SMCJ64A	SMCJ64CA	SMC	64.0	1	71.1	78.60	14.56	103.0	1500
SMCJ70A	SMCJ70CA	SMC	70.0	1	77.8	86.00	13.27	113.0	1500
SMCJ75A	SMCJ75CA	SMC	75.0	1	83.3	92.10	12.40	121.0	1500
SMCJ78A	SMCJ78CA	SMC	78.0	1	86.7	95.80	11.90	126.0	1500
SMCJ80A	SMCJ80CA	SMC	80.0	1	88.8	97.60	11.57	129.6	1500
SMCJ85A	SMCJ85CA	SMC	85.0	1	94.4	104.00	10.95	137.0	1500
SMCJ90A	SMCJ90CA	SMC	90.0	1	100.0	111.00	10.27	146.0	1500
SMCJ100A	SMCJ100CA	SMC	100.0	1	111.0	123.00	9.26	162.0	1500
SMCJ110A	SMCJ110CA	SMC	110.0	1	122.0	135.00	8.47	177.0	1500
SMCJ120A	SMCJ120CA	SMC	120.0	1	133.0	147.00	7.77	193.0	1500
SMCJ130A	SMCJ130CA	SMC	130.0	1	144.0	159.00	7.18	209.0	1500
SMCJ140A	SMCJ140CA	SMC	140.0	1	155.0	171.00	6.61	226.8	1500
SMCJ150A	SMCJ150CA	SMC	150.0	1	167.0	185.00	6.17	243.0	1500
SMCJ160A	SMCJ160CA	SMC	160.0	1	178.0	197.00	5.79	259.0	1500
SMCJ170A	SMCJ170CA	SMC	170.0	1	189.0	209.00	5.45	275.0	1500
SMCJ180A	SMCJ180CA	SMC	180.0	1	200.0	220.00	5.14	291.6	1500
SMCJ190A	SMCJ190CA	SMC	190.0	1	211.0	232.00	4.87	307.8	1500
SMCJ200A	SMCJ200CA	SMC	200.0	1	224.0	247.00	4.60	324.0	1500
SMCJ220A	SMCJ220CA	SMC	220.0	1	246.0	272.00	4.20	356.0	1500
SMCJ250A	SMCJ250CA	SMC	250.0	1	279.0	309.00	3.70	405.0	1500
SMCJ300A	SMCJ300CA	SMC	300.0	1	335.0	371.00	3.10	486.0	1500
SMCJ350A	SMCJ350CA	SMC	350.0	1	391.0	432.00	2.60	567.0	1500
SMCJ400A	SMCJ400CA	SMC	400.0	1	447.0	494.00	2.30	648.0	1500
SMCJ440A	SMCJ440CA	SMC	440.0	1	492.0	543.00	2.10	713.0	1500
SMDJ5.0A	SMDJ5.0CA	SMC	5.0	5000	6.4	7.00	326.09	9.2	3000
SMDJ6.0A	SMDJ6.0CA	SMC	6.0	5000	6.7	7.37	291.26	10.3	3000
SMDJ6.5A	SMDJ6.5CA	SMC	6.5	2000	7.2	7.98	267.86	11.2	3000
SMDJ7.0A	SMDJ7.0CA	SMC	7.0	1000	7.8	8.60	250.00	12.0	3000
SMDJ7.5A	SMDJ7.5CA	SMC	7.5	250	8.3	9.21	232.56	12.9	3000
SMDJ8.0A	SMDJ8.0CA	SMC	8.0	150	8.9	9.83	220.59	13.6	3000
SMDJ8.5A	SMDJ8.5CA	SMC	8.5	50	9.4	10.40	208.33	14.4	3000

Power Transient Voltage Suppressors

Part Number		Package	V _{RWM} (V)	I _R max(uA)	V _{BR} min(V)	V _{BR} max(V)	I _{PP} (A)	V _C max(V)	P _{PP} (W)
SMDJ9.0A	SMDJ9.0CA	SMC	9.0	20	10.0	11.10	194.81	15.4	3000
SMDJ10A	SMDJ10CA	SMC	10.0	15	11.1	12.30	176.47	17.0	3000
SMDJ11A	SMDJ11CA	SMC	11.0	2	12.2	13.50	164.84	18.2	3000
SMDJ12A	SMDJ12CA	SMC	12.0	2	13.3	14.70	150.75	19.9	3000
SMDJ13A	SMDJ13CA	SMC	13.0	2	14.4	15.90	139.53	21.5	3000
SMDJ14A	SMDJ14CA	SMC	14.0	2	15.6	17.20	129.31	23.2	3000
SMDJ15A	SMDJ15CA	SMC	15.0	2	16.7	18.50	122.95	24.4	3000
SMDJ16A	SMDJ16CA	SMC	16.0	2	17.8	19.70	115.38	26.0	3000
SMDJ17A	SMDJ17CA	SMC	17.0	2	18.9	20.90	108.70	27.6	3000
SMDJ18A	SMDJ18CA	SMC	18.0	2	20.0	22.10	102.74	29.2	3000
SMDJ19A	SMDJ19CA	SMC	19.0	2	21.1	23.30	97.47	30.8	3000
SMDJ20A	SMDJ20CA	SMC	20.0	2	22.2	24.50	92.59	32.4	3000
SMDJ22A	SMDJ22CA	SMC	22.0	2	24.4	26.90	84.51	35.5	3000
SMDJ24A	SMDJ24CA	SMC	24.0	2	26.7	29.50	77.12	38.9	3000
SMDJ26A	SMDJ26CA	SMC	26.0	2	28.9	31.90	71.26	42.1	3000
SMDJ28A	SMDJ28CA	SMC	28.0	2	31.1	34.40	66.08	45.4	3000
SMDJ30A	SMDJ30CA	SMC	30.0	2	33.3	36.80	61.98	48.4	3000
SMDJ33A	SMDJ33CA	SMC	33.0	2	36.7	40.60	56.29	53.3	3000
SMDJ36A	SMDJ36CA	SMC	36.0	2	40.0	44.20	51.64	58.1	3000
SMDJ40A	SMDJ40CA	SMC	40.0	2	44.4	49.10	46.51	64.5	3000
SMDJ43A	SMDJ43CA	SMC	43.0	2	47.8	52.80	43.23	69.4	3000
SMDJ45A	SMDJ45CA	SMC	45.0	2	50.0	55.30	41.27	72.7	3000
SMDJ48A	SMDJ48CA	SMC	48.0	2	53.3	58.90	38.76	77.4	3000
SMDJ51A	SMDJ51CA	SMC	51.0	2	56.7	62.70	36.41	82.4	3000
SMDJ54A	SMDJ54CA	SMC	54.0	2	60.0	66.30	34.44	87.1	3000
SMDJ58A	SMDJ58CA	SMC	58.0	2	64.4	71.20	32.05	93.6	3000
SMDJ60A	SMDJ60CA	SMC	60.0	2	66.7	73.70	30.99	96.8	3000
SMDJ64A	SMDJ64CA	SMC	64.0	2	71.1	78.60	29.13	103.0	3000
SMDJ70A	SMDJ70CA	SMC	70.0	2	77.8	86.00	26.55	113.0	3000
SMDJ75A	SMDJ75CA	SMC	75.0	2	83.3	92.10	24.79	121.0	3000
SMDJ78A	SMDJ78CA	SMC	78.0	2	86.7	95.80	23.81	126.0	3000
SMDJ80A	SMDJ80CA	SMC	80.0	2	88.8	97.60	23.15	129.6	3000
SMDJ85A	SMDJ85CA	SMC	85.0	2	94.4	104.00	21.90	137.0	3000
SMDJ90A	SMDJ90CA	SMC	90.0	2	100.0	111.00	20.55	146.0	3000
SMDJ100A	SMDJ100CA	SMC	100.0	2	111.0	123.00	18.52	162.0	3000
SMDJ110A	SMDJ110CA	SMC	110.0	2	122.0	135.00	16.95	177.0	3000
SMDJ120A	SMDJ120CA	SMC	120.0	2	133.0	147.00	15.54	193.0	3000
SMDJ130A	SMDJ130CA	SMC	130.0	2	144.0	159.00	14.35	209.0	3000

Power Transient Voltage Suppressors

Part Number		Package	V _{RWM} (V)	I _R max(μA)	V _{BR} min(V)	V _{BR} max(V)	I _{PP} (A)	V _C max(V)	P _{PP} (W)
SMDJ140A	SMDJ140CA	SMC	140.0	2	155.0	171.00	13.23	226.8	3000
SMDJ150A	SMDJ150CA	SMC	150.0	2	167.0	185.00	12.35	243.0	3000
SMDJ160A	SMDJ160CA	SMC	160.0	2	178.0	197.00	11.58	259.0	3000
SMDJ170A	SMDJ170CA	SMC	170.0	2	189.0	209.00	10.91	275.0	3000
SMDJ180A	SMDJ180CA	SMC	180.0	2	200.0	220.00	10.29	291.6	3000
SMDJ190A	SMDJ190CA	SMC	190.0	2	211.0	232.00	9.75	307.8	3000
SMDJ200A	SMDJ200CA	SMC	200.0	2	224.0	247.00	9.26	324.0	3000
SMDJ220A	SMDJ220CA	SMC	220.0	2	246.0	272.00	8.43	356.0	3000
SMDJ250A	SMDJ250CA	SMC	250.0	2	279.0	309.00	7.41	405.0	3000
SMDJ300A	SMDJ300CA	SMC	300.0	2	335.0	371.00	6.17	486.0	3000
SMDJ350A	SMDJ350CA	SMC	350.0	2	391.0	432.00	5.29	567.0	3000
SMDJ400A	SMDJ400CA	SMC	400.0	2	447.0	494.00	4.63	648.0	3000
SMDJ440A	SMDJ440CA	SMC	440.0	2	492.0	543.00	4.21	713.0	3000
5.0SMDJ5.0A	5.0SMDJ5.0CA	SMC	5.0	800	6.4	7.00	543.48	9.2	5000
5.0SMDJ6.0A	5.0SMDJ6.0CA	SMC	6.0	800	6.7	7.37	485.44	10.3	5000
5.0SMDJ6.5A	5.0SMDJ6.5CA	SMC	6.5	500	7.2	7.98	446.43	11.2	5000
5.0SMDJ7.0A	5.0SMDJ7.0CA	SMC	7.0	200	7.8	8.60	416.67	12.0	5000
5.0SMDJ7.5A	5.0SMDJ7.5CA	SMC	7.5	100	8.3	9.21	387.60	12.9	5000
5.0SMDJ8.0A	5.0SMDJ8.0CA	SMC	8.0	50	8.9	9.83	367.65	13.6	5000
5.0SMDJ8.5A	5.0SMDJ8.5CA	SMC	8.5	20	9.4	10.40	347.22	14.4	5000
5.0SMDJ9.0A	5.0SMDJ9.0CA	SMC	9.0	20	10.0	11.10	324.68	15.4	5000
5.0SMDJ10A	5.0SMDJ10CA	SMC	10.0	15	11.1	12.30	294.12	17.0	5000
5.0SMDJ11A	5.0SMDJ11CA	SMC	11.0	10	12.2	13.50	274.70	18.2	5000
5.0SMDJ12A	5.0SMDJ12CA	SMC	12.0	10	13.3	14.70	251.30	19.9	5000
5.0SMDJ13A	5.0SMDJ13CA	SMC	13.0	10	14.4	15.90	232.60	21.5	5000
5.0SMDJ14A	5.0SMDJ14CA	SMC	14.0	10	15.6	17.20	215.50	23.2	5000
5.0SMDJ15A	5.0SMDJ15CA	SMC	15.0	10	16.7	18.50	204.90	24.4	5000
5.0SMDJ16A	5.0SMDJ16CA	SMC	16.0	10	17.8	19.70	192.30	26.0	5000
5.0SMDJ17A	5.0SMDJ17CA	SMC	17.0	10	18.9	20.90	181.20	27.6	5000
5.0SMDJ18A	5.0SMDJ18CA	SMC	18.0	10	20.0	22.10	171.20	29.2	5000
5.0SMDJ19A	5.0SMDJ19CA	SMC	19.0	10	21.1	23.30	162.40	30.8	5000
5.0SMDJ20A	5.0SMDJ20CA	SMC	20.0	5	22.2	24.50	154.30	32.4	5000
5.0SMDJ22A	5.0SMDJ22CA	SMC	22.0	5	24.4	26.90	140.80	35.5	5000
5.0SMDJ24A	5.0SMDJ24CA	SMC	24.0	5	26.7	29.50	128.50	38.9	5000
5.0SMDJ26A	5.0SMDJ26CA	SMC	26.0	5	28.9	31.90	118.80	42.1	5000
5.0SMDJ28A	5.0SMDJ28CA	SMC	28.0	5	31.1	34.40	110.10	45.4	5000
5.0SMDJ30A	5.0SMDJ30CA	SMC	30.0	5	33.3	36.80	103.30	48.4	5000
5.0SMDJ33A	5.0SMDJ33CA	SMC	33.0	5	36.7	40.60	93.80	53.3	5000
5.0SMDJ36A	5.0SMDJ36CA	SMC	36.0	5	40.0	44.20	86.10	58.1	5000
5.0SMDJ40A	5.0SMDJ40CA	SMC	40.0	5	44.4	49.10	77.50	64.5	5000

Power Transient Voltage Suppressors

Part Number		Package	V _{RWM} (V)	I _R max(μA)	V _{BR} min(V)	V _{BR} max(V)	I _{PP} (A)	V _C max(V)	P _{PP} (W)
5.0SMDJ43A	5.0SMDJ43CA	SMC	43.0	5	47.8	52.80	72.00	69.4	5000
5.0SMDJ45A	5.0SMDJ45CA	SMC	45.0	5	50.0	55.30	68.80	72.7	5000
5.0SMDJ48A	5.0SMDJ48CA	SMC	48.0	5	53.3	58.90	64.60	77.4	5000
5.0SMDJ51A	5.0SMDJ51CA	SMC	51.0	5	56.7	62.70	60.70	82.4	5000
5.0SMDJ54A	5.0SMDJ54CA	SMC	54.0	5	60.0	66.30	57.40	87.1	5000
5.0SMDJ58A	5.0SMDJ58CA	SMC	58.0	5	64.4	71.20	53.40	93.6	5000
5.0SMDJ60A	5.0SMDJ60CA	SMC	60.0	5	66.7	73.70	51.70	96.8	5000
5.0SMDJ64A	5.0SMDJ64CA	SMC	64.0	5	71.1	78.60	48.50	103.0	5000
5.0SMDJ70A	5.0SMDJ70CA	SMC	70.0	5	77.8	86.00	44.20	113.0	5000
5.0SMDJ75A	5.0SMDJ75CA	SMC	75.0	5	83.3	92.10	41.30	121.0	5000
5.0SMDJ78A	5.0SMDJ78CA	SMC	78.0	5	86.7	95.80	39.70	126.0	5000
5.0SMDJ80A	5.0SMDJ80CA	SMC	80.0	5	88.8	97.60	38.60	129.6	5000
5.0SMDJ85A	5.0SMDJ85CA	SMC	85.0	5	94.4	104.00	36.50	137.0	5000
5.0SMDJ90A	5.0SMDJ90CA	SMC	90.0	5	100.0	111.00	34.20	146.0	5000
5.0SMDJ100A	5.0SMDJ100CA	SMC	100.0	5	111.0	123.00	30.90	162.0	5000
5.0SMDJ110A	5.0SMDJ110CA	SMC	110.0	5	122.0	135.00	28.20	177.0	5000
5.0SMDJ120A	5.0SMDJ120CA	SMC	120.0	5	133.0	147.00	25.90	193.0	5000
5.0SMDJ130A	5.0SMDJ130CA	SMC	130.0	5	144.0	159.00	23.90	209.0	5000
5.0SMDJ140A	5.0SMDJ140CA	SMC	140.0	5	155.0	171.00	22.00	226.8	5000
5.0SMDJ150A	5.0SMDJ150CA	SMC	150.0	5	167.0	185.00	20.60	243.0	5000
5.0SMDJ160A	5.0SMDJ160CA	SMC	160.0	2	178.0	197.00	19.31	259.0	5000
5.0SMDJ170A	5.0SMDJ170CA	SMC	170.0	2	189.0	209.00	18.18	275.0	5000
SM8S10A	SM8S10CA	DO-218AB	10.0	15	11.1	12.30	388.00	17.0	6600
SM8S11A	SM8S11CA	DO-218AB	11.0	10	12.2	13.50	363.00	18.2	6600
SM8S12A	SM8S12CA	DO-218AB	12.0	10	13.3	14.70	332.00	19.9	6600
SM8S13A	SM8S13CA	DO-218AB	13.0	10	14.4	15.90	307.00	21.5	6600
SM8S14A	SM8S14CA	DO-218AB	14.0	10	15.6	17.20	284.00	23.2	6600
SM8S15A	SM8S15CA	DO-218AB	15.0	10	16.7	18.50	270.00	24.4	6600
SM8S16A	SM8S16CA	DO-218AB	16.0	10	17.8	19.70	254.00	26.0	6600
SM8S17A	SM8S17CA	DO-218AB	17.0	10	18.9	20.90	239.00	27.6	6600
SM8S18A	SM8S18CA	DO-218AB	18.0	10	20.0	22.10	226.00	29.2	6600
SM8S20A	SM8S20CA	DO-218AB	20.0	10	22.2	24.50	204.00	32.4	6600
SM8S22A	SM8S22CA	DO-218AB	22.0	10	24.4	26.90	186.00	35.5	6600
SM8S24A	SM8S24CA	DO-218AB	24.0	10	26.7	29.50	170.00	38.9	6600
SM8S26A	SM8S26CA	DO-218AB	26.0	10	28.9	31.90	157.00	42.1	6600
SM8S28A	SM8S28CA	DO-218AB	28.0	10	31.1	34.40	145.00	45.4	6600
SM8S30A	SM8S30CA	DO-218AB	30.0	10	33.3	36.80	136.00	48.4	6600
SM8S33A	SM8S33CA	DO-218AB	33.0	10	36.7	40.60	124.00	53.3	6600

Power Transient Voltage Suppressors

Part Number		Package	V _{RWM} (V)	I _R max(uA)	V _{BR} min(V)	V _{BR} max(V)	I _{PP} (A)	V _C max(V)	P _{PP} (W)
SM8S36A	SM8S36CA	DO-218AB	36.0	10	40.0	44.20	114.00	58.1	6600
SM8S40A	SM8S40CA	DO-218AB	40.0	10	44.4	49.10	102.00	64.5	6600
SM8S43A	SM8S43CA	DO-218AB	43.0	10	47.8	52.80	95.10	69.4	6600

Thyristor Surge Suppressors

Part Number	Package	I _{PP} min(A)	V _{DRM} (V)	I _R max(uA)	V _S max(V)	I _H min(mA)	I _S max(mA)	I _T max(A)	V _T max(V)
CP0080SA	SMB	45	6	5	25	50	800	2.2	4
CP0080SB	SMB	80	6	5	25	50	800	2.2	4
CP0080SC	SMB	100	6	5	25	50	800	2.2	4
CP0300SA	SMB	45	25	5	40	50	800	2.2	4
CP0300SB	SMB	80	25	5	40	50	800	2.2	4
CP0300SC	SMB	100	25	5	40	50	800	2.2	4
CP0640SA	SMB	45	58	5	77	150	800	2.2	4
CP0640SB	SMB	80	58	5	77	150	800	2.2	4
CP0640SC	SMB	100	58	5	77	150	800	2.2	4
CP0720SA	SMB	45	65	5	88	150	800	2.2	4
CP0720SB	SMB	80	65	5	88	150	800	2.2	4
CP0720SC	SMB	100	65	5	88	150	800	2.2	4
CP0900SA	SMB	45	75	5	98	150	800	2.2	4
CP0900SB	SMB	80	75	5	98	150	800	2.2	4
CP0900SC	SMB	100	75	5	98	150	800	2.2	4
CP1100SA	SMB	45	90	5	130	150	800	2.2	4
CP1100SB	SMB	80	90	5	130	150	800	2.2	4
CP1100SC	SMB	100	90	5	130	150	800	2.2	4
CP1300SA	SMB	45	120	5	160	150	800	2.2	4
CP1300SB	SMB	80	120	5	160	150	800	2.2	4
CP1300SC	SMB	100	120	5	160	150	800	2.2	4
CP1500SA	SMB	45	140	5	180	150	800	2.2	4
CP1500SB	SMB	80	140	5	180	150	800	2.2	4
CP1500SC	SMB	100	140	5	180	150	800	2.2	4
CP1800SA	SMB	45	170	5	220	150	800	2.2	4
CP1800SB	SMB	80	170	5	220	150	800	2.2	4
CP1800SC	SMB	100	170	5	220	150	800	2.2	4
CP2300SA	SMB	45	190	5	260	150	800	2.2	4
CP2300SB	SMB	80	190	5	260	150	800	2.2	4
CP2300SC	SMB	100	190	5	260	150	800	2.2	4
CP2600SA	SMB	45	220	5	300	150	800	2.2	4
CP2600SB	SMB	80	220	5	300	150	800	2.2	4
CP2600SC	SMB	100	220	5	300	150	800	2.2	4
CP3100SA	SMB	45	275	5	350	150	800	2.2	4

Thyristor Surge Suppressors

Part Number	Package	I _{PP} min(A)	V _{DRM} (V)	I _R max(uA)	V _S max(V)	I _H min(mA)	I _S max(mA)	I _T max(A)	V _T max(V)
CP3500SA	SMB	45	320	5	400	150	800	2.2	4
CP3500SB	SMB	80	320	5	400	150	800	2.2	4
CP3500SC	SMB	100	320	5	400	150	800	2.2	4
CP4000SA	SMB	45	375	5	460	150	800	2.2	4
CP4000SB	SMB	80	375	5	460	150	800	2.2	4
CP4000SC	SMB	100	375	5	460	150	800	2.2	4
CP4200SA	SMB	45	400	5	520	150	800	2.2	4
CP4200SB	SMB	80	400	5	520	150	800	2.2	4
CP4200SC	SMB	100	400	5	520	150	800	2.2	4
CP4200SD	SMB	200	400	5	520	50	800	2.2	4

Programmable Thyristor Surge Suppressors

Part Number	Package	I _{PP} min(A)	V _{DRM} (V)	I _R max(uA)	I _{GT} max(mA)	I _H min(mA)
CG170D	SOP-8	40	170	5	5	150
CG170Q	SOP-8	40	170	5	5	150
CG110S	8-SOIC	45	110	5	5	150

Ceramic PTC Thermistors

Part Number	Package	Config	V _{RMS} max(V)	I max(A)	R std(ohm)	I _H max(mA)
CPS100M	PTH-1	Single	250V	3	10	150
CPS250M	PTH-1	Single	250V	3	25	90
CPS500M	PTH-1	Single	250V	3	50	60
CPT250M	SMT-1	Twin	250V	3	25	80
CPT500M	SMT-1	Twin	250V	3	50	60
CPT500KH	SMT-2	Twin	250V	3	50	90

Package Mechanical Specifications

DFN0603

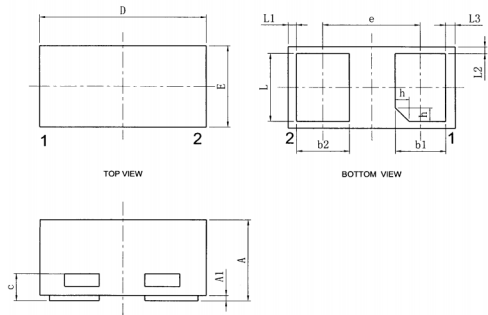

Symbol	Dimensions in millimeters		
	Min	Nom	Max
A	0.28	0.30	0.32
A1	0.00	0.02	0.05
b1	0.13	0.18	0.23
b2	0.14	0.19	0.24
c	0.05	0.10	0.15
D	0.55	0.60	0.65
e	0.35 BSC		
L1	0.030 BSC		
L3	0.035 BSC		
L2	0.025 BSC		
E	0.25	0.30	0.35
L	0.20	0.25	0.30
h	0.00	0.05	0.10

SOD-882

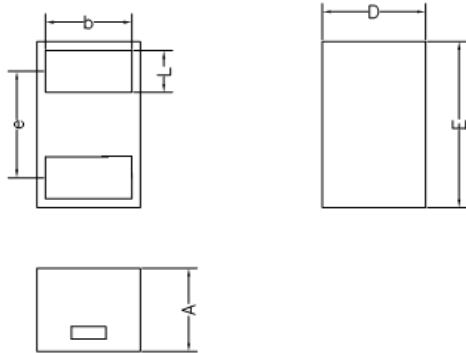

Symbol	Dimensions in millimeters		
	Min	Nom	Max
D	0.55	0.60	0.65
E	0.95	1.00	1.05
b	0.45	0.50	0.55
L	0.20	0.25	0.30
e	0.64 BSC		
A	0.45	0.50	0.55

DFN1006

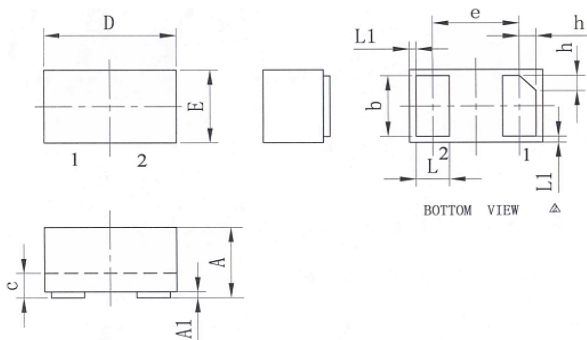

Symbol	Dimensions in millimeters		
	Min	Nom	Max
A	0.45	0.50	0.55
A1	0.00	0.02	0.05
b	0.45	0.50	0.55
c	0.12	0.15	0.18
D	0.95	1.00	1.05
e	0.65 BSC		
E	0.55	0.60	0.65
L	0.20	0.25	0.30
L1	0.05 REF		
h	0.07	0.12	0.17

SOD-923

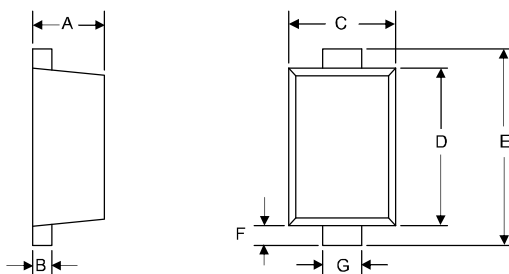

Symbol	Dimensions in millimeters	
	Min	Max
A	0.34	0.40
B	0.07	0.17
C	0.55	0.65
D	0.75	0.85
E	0.95	1.05
F	0.05	0.15
G	0.15	0.25

Package Mechanical Specifications

SOD-523

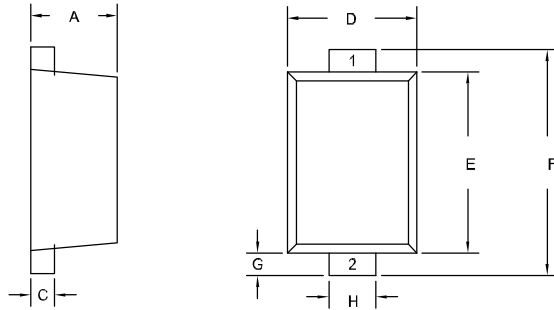

Symbol	Dimensions in millimeters	
	Min	Max
A	0.50	0.70
C	0.07	0.20
D	0.70	0.90
E	1.10	1.30
F	1.50	1.70
G	0.15	0.25
H	0.25	0.35

SOD-323

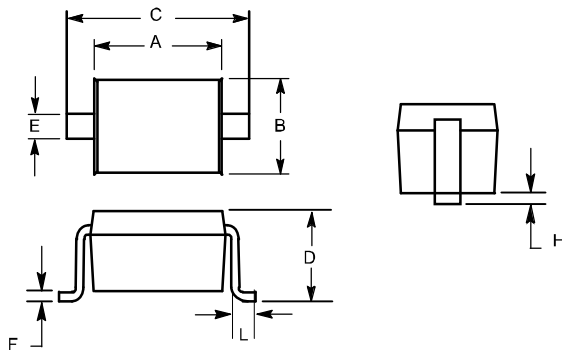

Symbol	Dimensions in millimeters	
	Min	Max
A	1.60	1.90
B	1.15	1.45
C	2.39	2.70
D	0.80	1.10
E	0.25	0.40
F	0.10	0.20
H	-	0.10
L	0.20	-

SOT-883

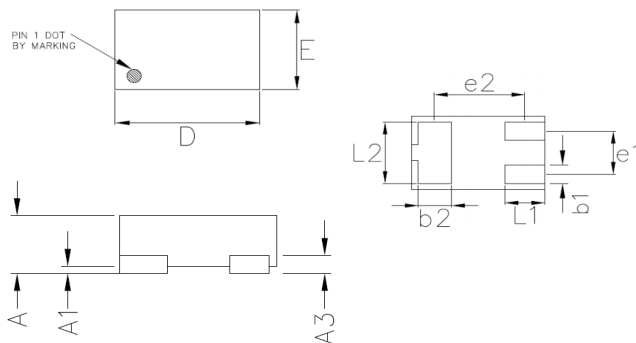

Symbol	Dimensions in millimeter		
	Min.	Nom	Max.
A	0.40	-	0.50
A1	0.00	-	0.05
A3	0.125 REF		
D	0.95	1.00	1.05
E	0.55	0.60	0.65
b1	0.10	0.15	0.20
b2	0.20	0.25	0.30
L1	0.20	0.30	0.40
L2	0.40	0.50	0.60
e1	0.350 BSC		
e2	0.675 BSC		

SOT-523

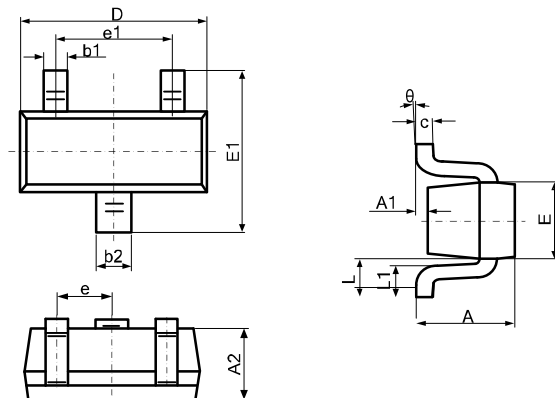

Symbol	Dimensions in millimeters	
	Min	Max
A	0.700	0.900
A1	0.000	0.100
A2	0.700	0.800
b1	0.150	0.250
b2	0.250	0.325
c	0.100	0.200
D	1.500	1.700
E	0.750	0.850
E1	1.450	1.750
e	0.950 BSC	
e1	0.900	1.100
L	0.300	0.500
L1	0.028	0.440
theta	0	8°

Package Mechanical Specifications

SOT-23

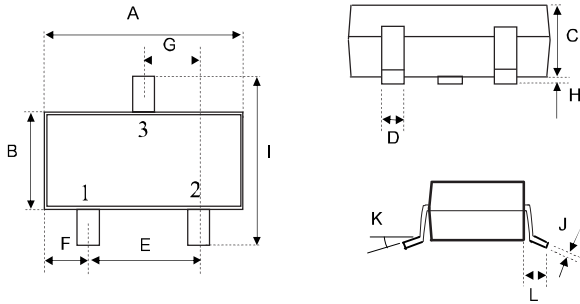

Symbol	Dimensions in millimeters	
	Min	Max
A	2.80	3.04
B	1.20	1.40
C	0.89	1.11
D	0.37	0.50
E	1.78	2.04
F	0.45	0.60
G	0.89	1.02
H	0.013	0.100
I	2.10	2.50
J	0.085	0.177
K	0°	10°
L	0.45	0.60

SOT-143

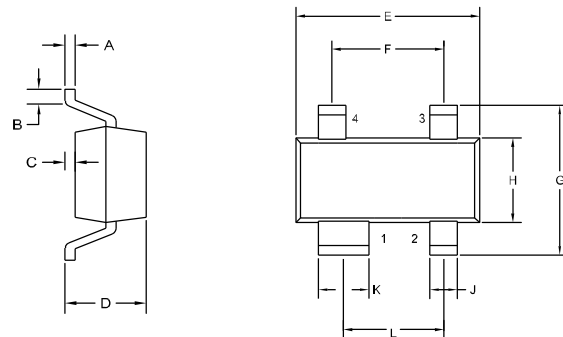

Symbol	Dimensions in millimeters	
	Min	Max
A	0.08	0.15
B	0.15	-
C	-	0.13
D	-	1.14
E	2.79	3.04
F	1.90	
G	-	2.50
H	1.19	1.40
J	0.36	0.50
K	0.76	0.93
L	1.70	

SOT-353

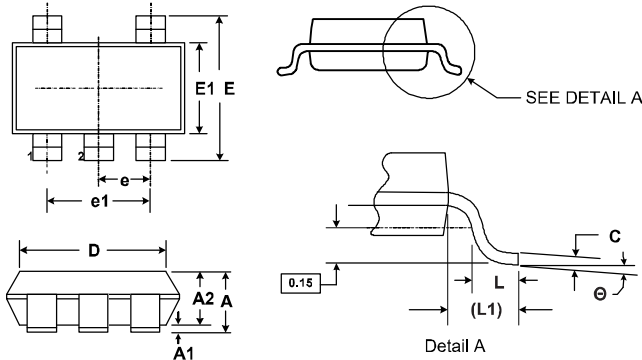

Symbol	Dimensions in millimeters	
	Min	Max
A	0.900	1.100
A1	0.000	0.100
A2	0.900	1.000
D	2.000	2.200
E1	1.150	1.350
E	2.150	2.450
e	0.650 TYP	
e1	1.200	1.400
L	0.525 REF	
L1	0.260	0.460
θ	8°	0°

SOT-363

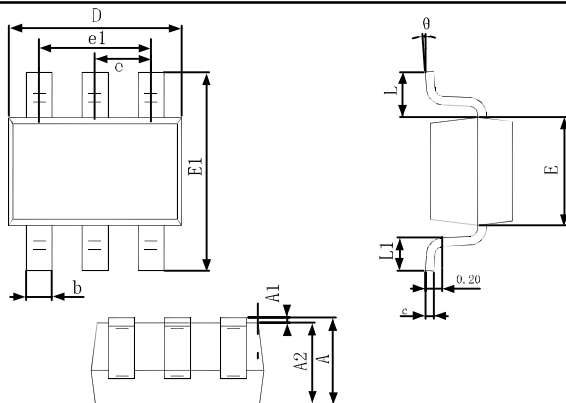

Symbol	Dimensions in millimeters		
	Min	Nom	Max
A	0.90	1.00	1.10
A1	0.00	0.05	0.10
A2	0.90	0.95	1.00
b	0.15	0.25	0.35
c	0.10	0.13	0.15
D	2.00	2.10	2.20
E	1.15	1.25	1.35
E1	2.15	2.28	2.40
e	0.650 BSC		
e1	1.20	1.30	1.40
L	0.525 BSC		
L1	0.26	0.36	0.46
θ	0°	4°	8°

Package Mechanical Specifications

SOT-553

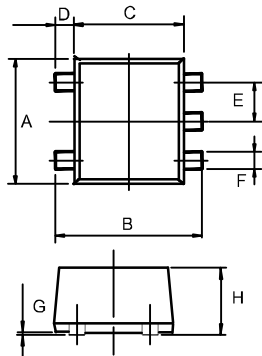

Symbol	Dimensions in millimeters	
	Min	Max
A	1.50	1.70
B	1.50	1.70
C	1.10	1.30
D	0.10	0.30
E	0.50BSC	
F	0.17	0.27
G	0.00	0.05
H	0.50	0.60
I	7°REF	7°REF
J	0.08	0.16

SOT-563

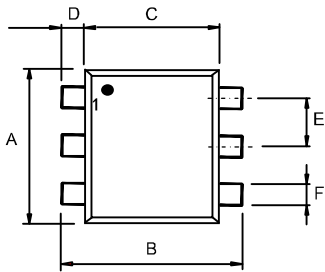

Symbol	Dimensions in millimeters	
	Min	Max
A	1.50	1.70
B	1.50	1.70
C	1.10	1.30
D	0.10	0.30
E	0.50BSC	
F	0.17	0.27
G	0.50	0.60
H	0.08	0.16

SOT23-6

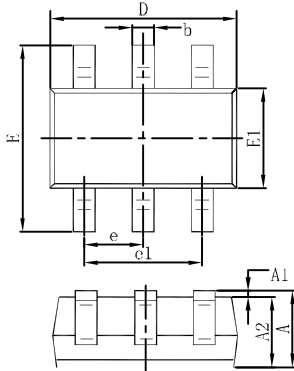

Symbol	Dimensions in millimeters	
	Min	Max
A	1.050	1.250
A1	0.000	0.100
A2	1.050	1.150
b	0.300	0.500
c	0.100	0.200
D	2.820	3.020
E	1.500	1.700
E1	2.650	2.950
e	0.950(BSC)	
e1	1.800	2.000
L	0.300	0.600
theta	0°	8°

DFN1308

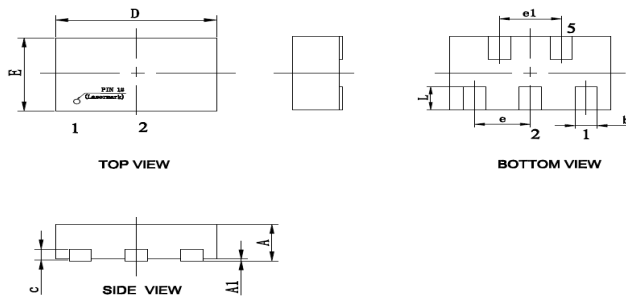

Symbol	Dimensions in millimeters		
	Min	Nom	Max
A	0.37	0.40	0.43
A1	0.00	0.02	0.05
b	0.13	0.18	0.23
c	0.08	0.13	0.18
D	1.20	1.30	1.40
e	0.45 BSC		
e1	0.50 BSC		
E	0.70	0.80	0.90
L	0.20	0.25	0.30

Package Mechanical Specifications

DFN1610

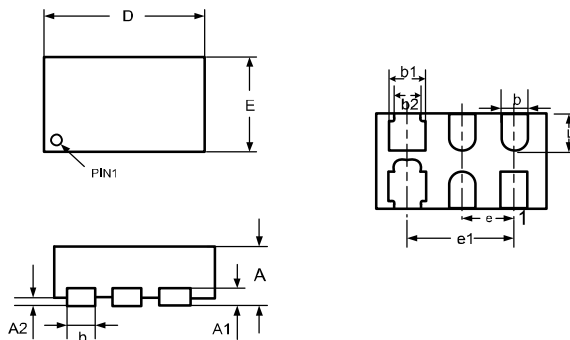

Symbol	Dimensions in millimeters	
	Min	Max
D	1.55	1.65
E	0.95	1.05
L	0.33	0.43
b	0.15	0.25
b1	0.35	0.45
b2	0.25	0.35
e	0.50BSC	
e1	1.00BSC	
A	0.45	0.55
A1	0.15REF	
A2	0.00	0.05

DFN1616

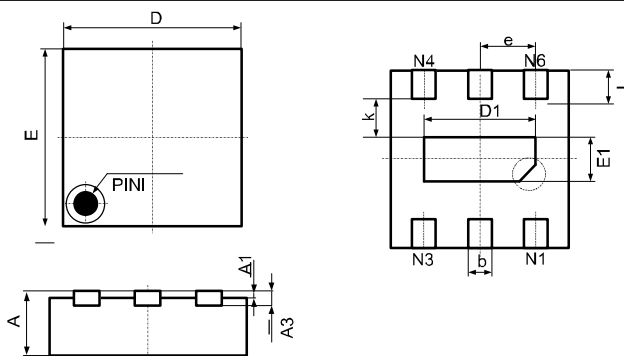

Symbol	Dimensions in millimeters	
	Min	Max
A	0.550	0.650
A1	0.000	0.050
A3	0.152REF	
D	1.550	1.650
E	1.550	1.650
E1	0.500	0.700
D1	0.900	1.100
k	0.200MIN.	
b	0.200	0.300
e	0.500 BSC.	
L	0.164	0.316

DFN2010

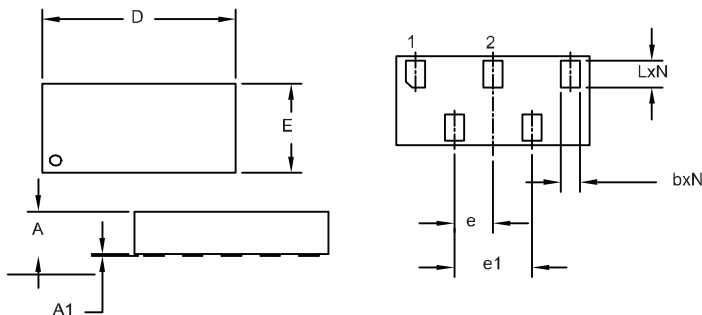

Symbol	Dimensions in millimeters		
	Min	Nom	Max
A	0.45	0.50	0.55
A1	0.00	0.02	0.05
b	0.15	0.20	0.25
D	1.95	2.00	2.05
E	0.95	1.00	1.05
e	0.40 BSC		
e1	0.80 BSC		
L	0.25	0.30	0.35
N	5		

DFN2020-6L

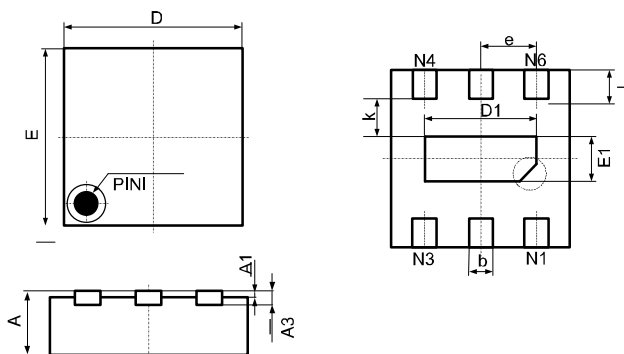

Symbol	Dimensions in millimeters	
	Min	Max
A	0.70	0.80
A1	0.000	0.050
A3	0.18	0.25
D	1.90	2.10
E	1.90	2.10
E1	0.90	1.10
D1	1.50	1.70
k	0.20	-
b	0.25	0.35
e	0.650 BSC.	
L	0.20	0.30

Package Mechanical Specifications

DFN2020-3L

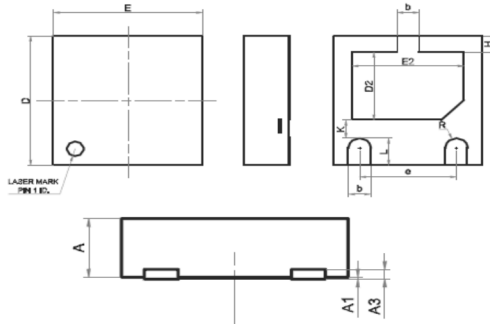

Symbol	Dimensions in millimeters		
	Min	Nom	Max
A	0.51	0.55	0.60
A1	0.00	0.02	0.05
A3	0.15 REF.		
b	0.25	0.30	0.35
D	1.90	2.00	2.10
E	1.90	2.00	2.10
D2	0.85	1.00	1.10
E2	1.35	1.50	1.60
e	1.20	1.30	1.40
H	0.20	0.25	0.30
K	0.20	0.30	0.40
L	0.35	0.40	0.45
R	0.15	-	-

DFN2510

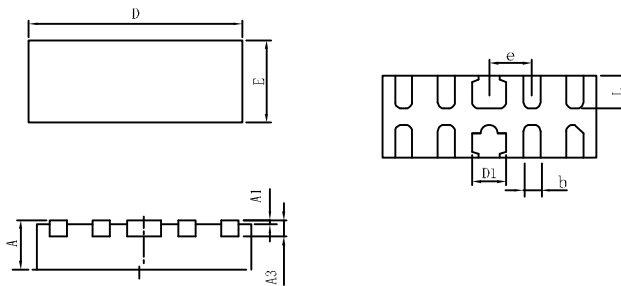

Symbol	Dimensions in millimeters		
	Min	Nom	Max
A	0.45	0.50	0.55
A1	-	0.02	0.05
A3	0.10	0.15	0.20
D	2.45	2.50	2.55
E	0.95	1.00	1.05
D1	0.35	0.40	0.45
b	0.15	0.20	0.25
e	0.50BSC		
L	0.35	0.40	0.45

DFN2626

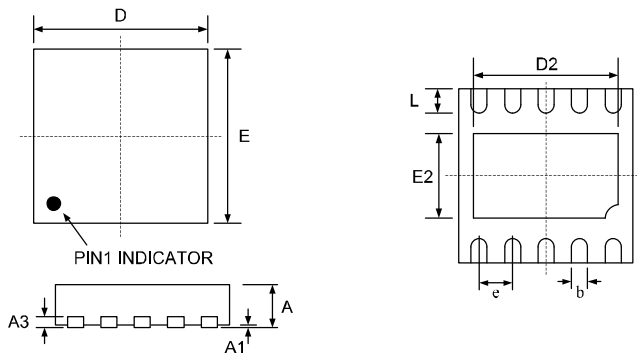

Symbol	Dimensions in millimeters		
	Min	Nom	Max
A	0.500	0.550	0.600
A1	0.000	—	0.050
A3	0.15 REF.		
b	0.200	0.250	0.300
D	2.550	2.600	2.650
D2	2.000	2.150	2.250
e	0.500 BSC		
E	2.550	2.600	2.650
E2	1.110	1.260	1.360
L	0.250	0.350	0.450

DFN3020

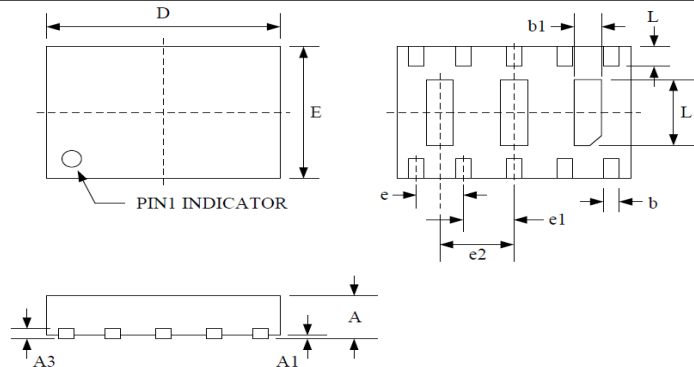

Symbol	Dimensions in millimeters		
	Min	Nom	Max
A	0.500	0.600	0.650
A1	0.000	0.030	0.050
A3	0.15 REF.		
b	0.150	0.200	0.250
b1	0.250	0.350	0.450
D	2.900	3.000	3.100
E	1.900	2.000	2.100
e	0.600 BSC		
e1	0.650 BSC		
e2	0.950 BSC		
L	0.250	0.300	0.350
L1	0.950	1.000	1.050

Package Mechanical Specifications

DFN3310

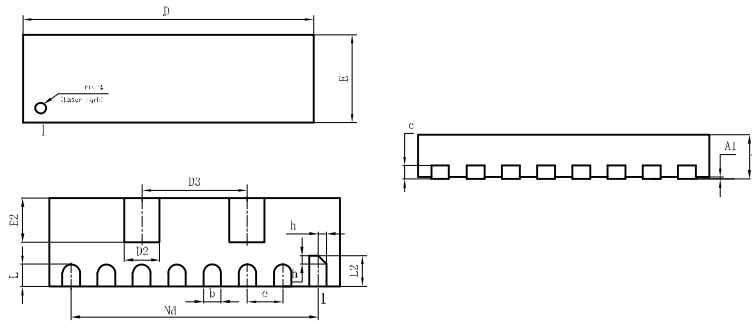

Symbol	Dimensions in millimeters		
	Min	Nom	Max
A	0.45	0.50	0.55
A1	—	0.02	0.05
b	0.15	0.20	0.25
c	0.100	0.152	0.200
D	3.25	3.30	3.35
D2	0.30	0.35	0.40
D3	1. 19BSC		
e	0.40BSC		
Nd	2. 80BSC		
E	0.95	1.00	1.05
E2	0.45	0.50	0.55
L	0.20	0.25	0.30
L2	0.30	0.35	0.40
h	0.05	0.10	0.15

DFN3810

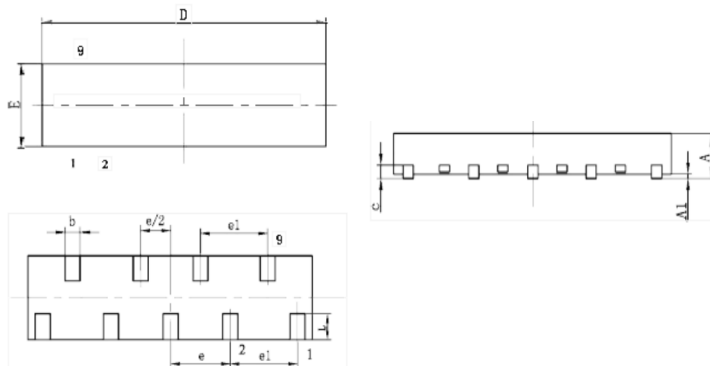

Symbol	Dimensions in millimeters		
	Min	Nom	Max
A	0.45	0.50	0.55
A1	—	0.02	0.05
b	0.15	0.20	0.25
c	0.10	0.15	0.20
D	3.75	3.80	3.90
e	0.80 BSC		
e1	0.90 BSC		
E	0.90	1.00	1.10
L	0.20	0.30	0.40

DFN4120

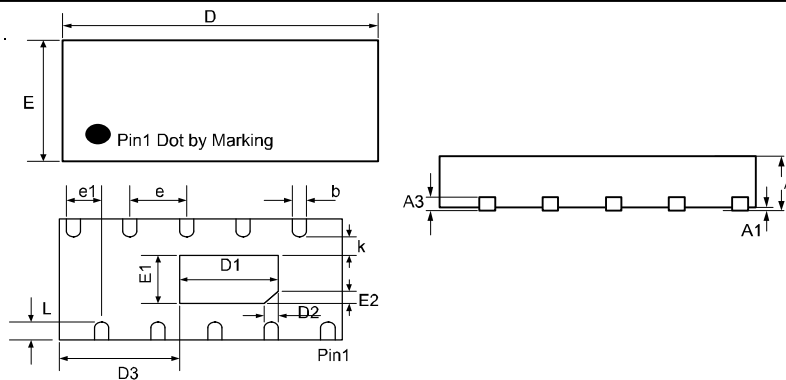

Symbol	Dimensions in millimeters	
	Min	Max
A	0.450	0.550
A1	0.000	0.050
A3	0.152REF	
D	4.050	4.150
E	1.950	2.050
D1	1.300	1.500
E1	0.700	0.900
D3	1.650	1.850
D2	0.200REF	
E2	0.200REF	
k	0.200MIN	
b	0.150	0.250
e	0.800TYP	
e1	0.350	0.450
L	0.250	0.350

SOD-123FL

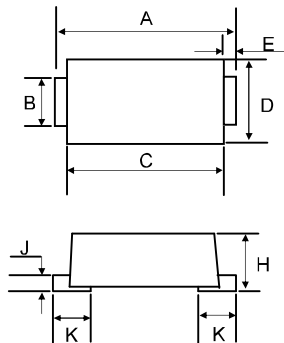

Symbol	Dimensions in millimeters		
	Min	Nom	Max
A	3.50	3.70	3.90
B	0.75	0.85	0.95
C	2.60	2.80	3.00
D	1.60	1.80	2.00
E	0.45Typ		
H	0.9	1.05	1.2
J	0.12	0.17	0.22
K	0.8Typ		

Package Mechanical Specifications

SMA

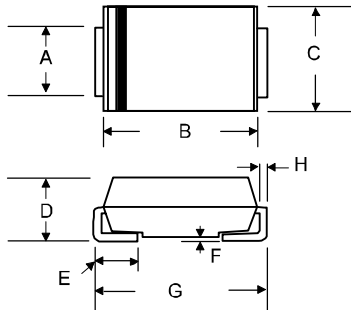

Symbol	Dimensions in millimeters	
	Min	Max
A	1.27	1.63
B	4.00	4.60
C	2.40	2.65
D	1.90	2.25
E	0.80	1.50
F	0.10	0.20
G	4.80	5.20
H	0.15	0.31

SMB

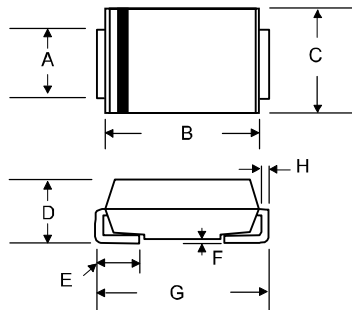

Symbol	Dimensions in millimeters	
	Min	Max
A	1.93	2.08
B	4.25	4.75
C	3.48	3.73
D	1.99	2.61
E	0.90	1.41
F	0.10	0.20
G	5.26	5.46
H	0.15	0.31

SMC

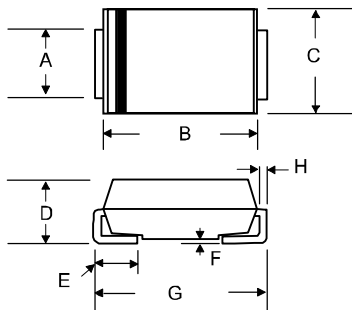

Symbol	Dimensions in millimeters	
	Min	Max
A	2.92	3.07
B	6.60	7.11
C	5.59	6.22
D	2.00	2.62
E	0.76	1.52
F	0.10	0.20
G	7.75	8.13
H	0.15	0.31

DO-218AB

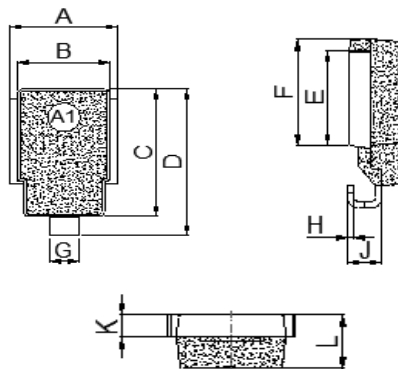

Symbol	Dimensions in millimeters	
	Min	Max
A	9.5	10.5
B	8.3	8.7
C	13.3	13.7
D	15.0	16.0
E	8.5	9.1
F	9.5	10.1
G	2.4	3.0
H	0.5	0.7
J	2.7	3.7
K	1.9	2.1
L	4.7	5.1

Package Mechanical Specifications

SOP-8

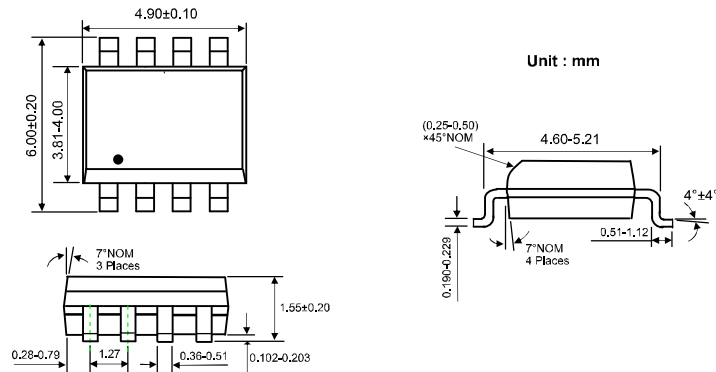

8-SOIC

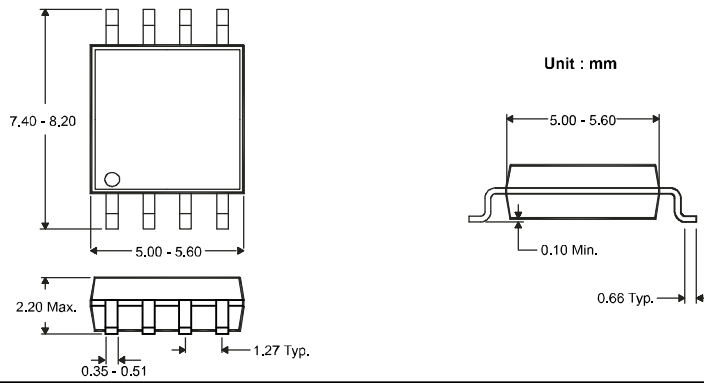

PTH-1

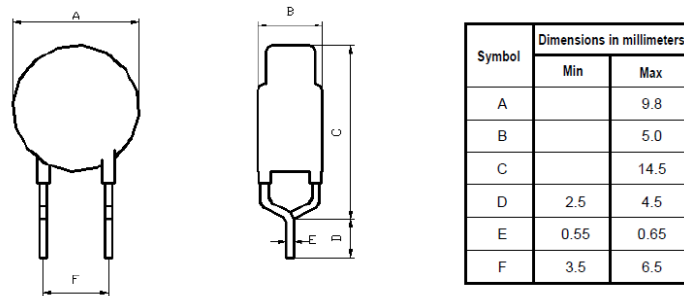

SMT-1

